

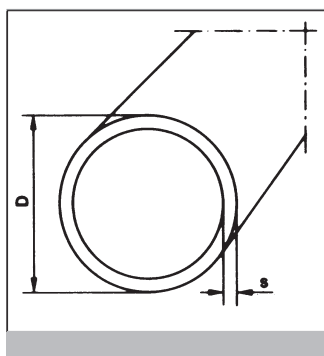

buizen
tuyaux
pipes

PVDF-SOLEF®



DRUKBUIS
TUYAU DE PRESSION
PRESSURE PIPE

L = 5 m

Spanningsvrije buizen / Exempt de tensions internes / Free from internal strain

D	SDR 33 / ISO S-16			SDR 21 / ISO S-10			SDR 13.6 / ISO S-6,3		
	s	KG/M	€/M	s	KG/M	€/M	s	KG/M	€/M
16							1.9	0.163	19.61
20				1.9	0.21	25.20			
25				1.9	0.27	32.45			
32				2.4	0.44	52.89			
40				2.4	0.55	66.30			
50				3.0	0.85	102.41			
63	2.0	0.75	90.09	3.0	1.09	131.25			
75	2.3	1.11	133.55	3.6	1.55	186.66			
90	2.8	1.48	178.06	4.3	2.22	267.31			
110	3.4	2.20	264.79	5.3	3.32	399.65			
125	3.9	2.84	341.81	6.0	4.24	510.25			
140	4.3	3.52	423.70	6.7	5.31	638.98			
160	4.9	4.54	546.46	7.7	6.96	837.65			
180	5.5	5.74	690.87	8.6	8.74	1,051.73			
200	6.2	7.19	865.55	9.6	10.70	1,292.65			
225	6.9	8.95	1,077.29	10.8	13.70	1,645.13			
250	7.7	11.10	1,334.81	11.9	16.73	2,013.53			
280	8.6	13.90	1,668.25	13.4	21.10	2,568.12			
315	9.7	17.60	2,112.26						
355	10.8	22.00	2,647.74						
400	12.2	28.03	3,373.29						

Eveneens leverbaar : PURAD Ultra High Purity - klasse 100, ISO-5 : Buizen en fittingen prijzen + 7%, kranen op aanvraag.

Egalement livrable : PURAD Ultra High Purity - classe 100, ISO-5: Tuyaux et raccords prix + 7%, vannes sur demande.

Also available : PURAD Ultra High Purity - class 100, ISO-5 : Pipes and fittings prices + 7%, valves on request.



stomplasmafittings - IR
 raccords pour le soudage bout à bout - IR
 fittings for butt welding - IR

PVDF-SOLEF®

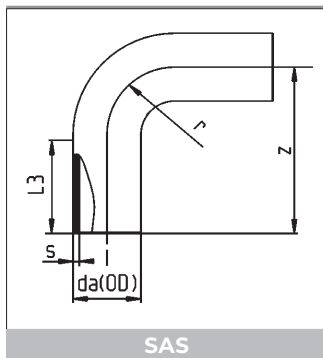

MULTI-BOCHTEN 90°, VERLENGD
 MULTI-COUCDES 90°, ALLONGES
 MULTI-ELBOWS 90°, ELONGATED

Type geschikt voor stomplasma / IR + HPF lassen.
 Type fait pour soudage bout à bout / IR + HPF.
 Type suitable for butt welding / IR + HPF fusion.

D	L3	z	r	SDR 33 / ISO S-16		SDR 21 / ISO S-10			
				s	KG/ST/PC	€/ST/PC	s	KG/ST/PC	€/ST/PC
20	32	51	20			1.9	0.030	9.07	
25	33	56	25			1.9	0.040	12.25	
32	33	63	32			2.4	0.060	24.03	
40	36	72	40			2.4	0.080	37.75	
50	36	84	50			3.0	0.140	57.17	
63	38	97	63			3.0	0.210	96.29	
75	28	100	75			3.6	0.320	163.89	
90	34	123	90	2.8	0.383	222.50	4.3	0.530	273.04
110	34	142	110	3.4	0.662	299.86	5.3	0.930	409.49
140	73	216	140	4.3	1.390	575.51	5.7	1.847	870.28
160	73	236	160	4.9	1.915	853.97	7.7	2.632	1299.06
225	73	301	225	6.9	5.000	2223.37	10.8	6.512	3376.32

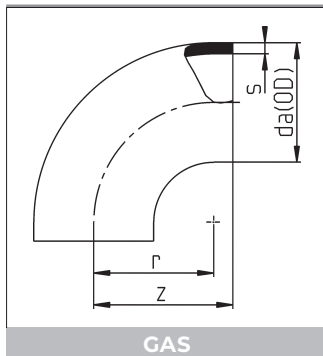

BOCHTEN 90°
 COUCDES 90°
 ELBOWS 90°

Gespoten.
 Injectés.
 Moulded.

da	r	z	SDR 33 / ISO S-16		SDR 21 / ISO S-10			
			s	KG/ST/PC	€/ST/PC	s	KG/ST/PC	€/ST/PC
125	125	135	3.9	0.647	435.26	6.0	0.944	591.44
180	175	200	5.5	2.000	675.47	8.6	2.870	918.71
200	196	217	6.2	2.756	797.50	9.6	3.775	1084.58
250	250	287	7.7	5.460	1586.19	11.9	8.210	2467.24
280	280	288	8.6	6.965	1763.61	13.4	10.290	2630.88
315	300	338	9.7	10.100	2273.40			



stomplasmafittings - IR
raccords pour le soudage bout à bout - IR
fittings for butt welding - IR

PVDF-SOLEF®

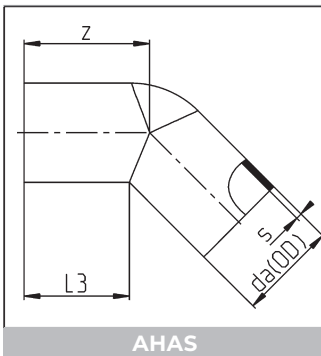

BOCHTEN 45°, VERLENGD / GESPOTEN
COUDES 45°, ALLONGES / INJECTES
ELBOWS 45°, ELONGATED / MOULDED

D	I3	Z	SDR 33 / ISO S-16			SDR 21 / ISO S-10		
			s	KG/ST/PC	€/ST/PC	s	KG/ST/PC	€/ST/PC
20	39	43				1.9	0.020	11.46
25	40	45				1.9	0.027	12.62
32	46	52				2.4	0.051	18.62
40	50	58				2.4	0.069	29.59
50	56	66				3.0	0.125	38.91
63	62	75				3.0	0.177	61.73
75	32	50				3.6	0.151	122.74
90	36	59	2.8	0.173	189.76	4.3	0.245	221.63
110	45	68	3.4	0.308	246.61	5.3	0.461	319.00
140	57	85	4.3	0.628	567.50	6.7	0.890	664.19
160	65	103	4.9	0.913	639.07	7.7	1.370	745.19

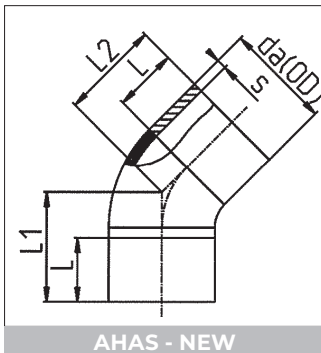

D	L2	L	L1	SDR 33 / ISO S-16			SDR 21 / ISO S-10		
				s	KG/ST/PC	€/ST/PC	s	KG/ST/PC	€/ST/PC
125	152	100	162	3.9	0.893	667.14	6.0	1.32	897.12
180	172	100	197	5.5	2.150	1015.44	8.6	3.18	1389.92
200	181	100	202	6.2	2.820	1170.70	9.6	4.05	1664.17
225	193	100	211	6.9	3.630	1782.09	10.8	5.36	2574.01
250	204	100	241	7.7	4.940	1935.91	11.9	7.25	3028.97
280	216	100	224	8.6	6.310	2122.00	13.4	9.37	3299.26
315	224	100	262	9.7	8.475	2712.31	-	-	-

L = 100 mm gelast / soudé / welded

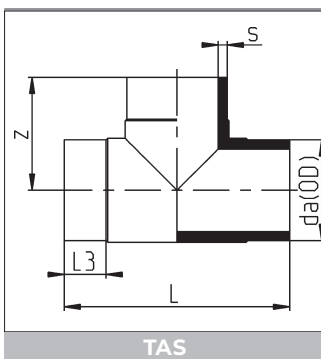

T-STUKKEN 90°, GESPOTEN
TES A 90°, INJECTES
TEES 90°, MOULDED

D	L	z	L3	SDR 33 / ISO S-16			SDR 21 / ISO S-10		
				s	KG/ST/PC	€/ST/PC	s	KG/ST/PC	€/ST/PC
20	75	38	25.0				1,9	0.023	13.02
25	84	42	25.0				1,9	0.032	16.44
32	90	46	25.0				2,4	0.060	23.73
40	116	58	31.0				2,4	0.080	37.85
50	126	64	31.0				3.0	0.154	41.64
63	140	70	31.0				3.0	0.230	88.87
75	178	89	42.0				3,6	0.379	169.70
90	185	92	33,5	2,8	0.468	247.42	4,3	0.618	291.48
110	221	110	33,5	3,4	0.868	276.57	5,3	1.150	361.40
125	279	139	52.0	3,9	1.210	460.08	6,0	1.650	625.34
140	308	154	60.0	4,3	1.715	507.14	6,7	2.276	695.07
160	279	140	45.0	4,9	1.920	614.30	7,7	2.640	798.36
180	400	200	80.0	5,5	3.280	712.62	8,6	4.680	967.20
200	446	223	89.0	6,2	5.530	1054.87	9,6	7.085	1434.07
225	496	246	99.0	6,9	6.720	1351.25	10,8	9.300	1847.63
250	500	250	80.0	7,7	8.235	1682.26	11,9	11.400	2754.79
280	495	248	70.0	8,6	9.900	1917.61	13,4	13.890	3506.08
315	496	247	57.0	9,7	12.060	2736.02			



stomplasmafittings - IR
raccords pour le soudage bout à bout - IR
fittings for butt welding - IR

PVDF-SOLEF®

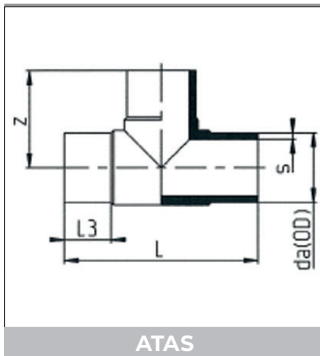

T-STUKKEN 90° - VERLENGD
TES A 90° - ALLONGES
TEES 90° - ALLONGATED

SDR 21 / ISO S-10

da	s	z	L	L3	KG/ST/PC	€/ST/PC
20	1.9	55	109	36	0.042	30.47
25	1.9	59	117	40	0.059	35.24
32	2.4	72	143	45	0.113	42.26

* PURAD

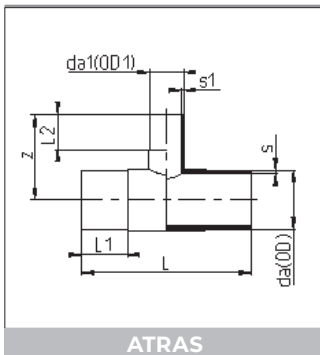

T-REDUCTIE STUKKEN - VERLENGD
TES REDUCES - ALLONGES
REDUCED TEES - ALLONGATED

Gespoten.
Injectés.
Moulded.

da	da1	z	L	SDR 33 / ISO S-16		SDR 21 / ISO S-10				SDR 33/21 / ISO S-16/10*					
				s	s1	KG	€	s	s1	KG	€	s	s1	KG	€
				ST/PC	ST/PC	ST/PC		ST/PC							
63	20	70.5	97			3.0	1.9	0.125	170.15						
63	25	70.5	102			3.0	1.9	0.133	170.15						
63	32	70.5	109			3.0	2.4	0.147	170.15						
63	40	70.5	117			3.0	2.4	0.200	170.15						
63	50	70.5	127			3.0	3.0	0.199	170.15						
90	20	95.0	230			4.3	1.9	0.663	288.91						
90	25	95.0	230			4.3	1.9	0.645	288.91						
90	32	95.0	230			4.3	2.4	0.686	298.92						
90	40	95.0	230			4.3	2.4	0.674	298.92						
90	50	95.0	230			4.3	3.0	0.713	298.92						
90	63	95.0	230			4.3	3.0	0.685	298.92	2.8	3.0	0.582	281.81		
110	20	105.0	230			5.3	1.9	0.978	419.68						
110	25	105.0	230			5.3	1.9	0.983	419.68						
110	32	105.0	230			5.3	2.4	0.997	419.68						
110	40	105.0	230			5.3	2.4	0.986	419.68						
110	50	105.0	230			5.3	3.0	0.932	419.68						
110	63	105.0	230			5.3	3.0	0.986	450.41	3.4	3.0	0.943	436.91		
110	90	150.0	313	3.4	2.8	1.005	436.90	5.3	4.3	1.370	450.41				
160	63	175.0	345			7.7	3.0	2.837	840.77	4.9	3.0	2.055	795.28		
160	90	183.0	348	4.9	2.8	2.400	807.15	7.7	4.3	3.250	975.86	4.9	4.3	2.520	837.19
160	110	183.0	349	4.9	3.4	2.700	843.21	7.7	5.3	3.490	1009.81	4.9	5.3	2.830	878.26
225	90	175.0	353							6.9	4.3	4.401	1257.19		
225	110	170.0	350					10.8	5.3	5.697	1587.01	6.9	5.3	4.200	1257.19

* Bij deze uitvoering is de aftakking SDR 21 en de hoofdleiding SDR 33 / Ici le branche est SDR 21 et la conduite principale est SDR 33 / In this version the branch is SDR 21 and the main line is SDR 33.



stomplasfittings - IR
raccords pour le soudage bout à bout - IR
fittings for butt welding - IR

PVDF-SOLEF®

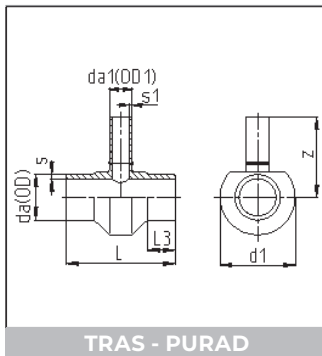

VERLOOP T-STUKKEN 90°
TES REDUITS A 90°
TEES 90° REDUCING

SDR 21 / ISO S-10

da	da1	s	z	L3	s1	d1	L	KG/ST/PC	€/ST/PC
63	20	3	137.0	23,5	1,9	84	120	0.372	731.77
63	25	3	137.0	23,5	1,9	84	120	0.400	731.77
75	20	3,6	145,5	25.0	1,9	105	120	0.590	947.42
75	25	3,6	145,5	25.0	1,9	105	120	0.590	947.42
75	32	3,6	149,5	35.0	2,4	85	140	0.380	947.42
90	75	4,3	155.0	57,5	3,6	130	230	1.605	1188.16
110	75	5,3	163.0	57,5	3,6	150	230	2.115	1447.60
140	20	6,7	176,5	31,5	1,9	157	158	1.400	1846.32
140	25	6,7	176,5	31,5	1,9	157	158	1.200	1846.32
140	32	6,7	176,5	31,5	2,4	157	158	1.440	1846.32
140	40	6,7	182.0	50.0	2,4	150	210	1.610	1846.32
140	50	6,7	182.0	50.0	3.0	150	210	1.640	1846.32
140	63	6,7	182.0	50.0	3.0	150	210	1.610	1846.32
140	90	6,7	178.0	35.0	4,3	178	180	2.990	1846.32
140	110	6,7	182.0	42.0	5,3	178	230	3.014	1846.32
160	20	7,7	187,5	31.0	1,9	178	158	1.730	2709.56
160	25	7,7	187,5	31.0	1,9	178	158	1.224	2709.56
160	32	7,7	187,5	26.0	2,4	178	158	1.770	2709.56
160	40	7,7	192.0	50.0	2,4	170	210	2.020	2709.56
160	50	7,7	192.0	50.0	3.0	170	210	2.010	2709.56
160	63	7,7	192.0	50.0	3.0	170	210	2.010	2709.56
160	75	7,7	190.0	42.0	3,6	200	210	3.450	2709.56
225	20	10,8	220.0	30.0	1,9	250	130	2.310	8003.46
225	40	10,8	220.0	30.0	2,4	246	130	3.110	8003.46
225	63	10,8	220.0	40.0	3.0	260	165	3.600	8003.46
225	75	10,8	222.0	60.0	3,6	260	230	5.240	8003.46
225	90	10,8	220.0	50.0	4,3	265	230	6.020	8003.46
225	110	10,8	220.0	52.0	5,3	278	280	6.470	8003.46
225	140	10,8	227,5	50.0	6,7	265	280	7.505	8003.46
225	160	10,8	227,5	39.0	7,7	275	280	8.598	8003.46

SDR 33/21 - MOP 10 bar

da	da1	s	z	L3	s1	d1	L	KG/ST/PC	€/ST/PC
90	20	2,8	150,5	37.0	1,9	105	149	0.521	1188.16
90	25	2,8	150,5	37.0	1,9	105	149	0.360	1188.16
90	32	2,8	149,5	37.0	2,4	105	149	0.374	1188.16
110	20	3,4	160,5	38.0	1,9	124	150	0.615	1447.60
110	25	3,4	160,5	38.0	1,9	124	150	0.532	1447.60
110	32	3,4	159,5	38.0	2,4	124	150	0.678	1447.60
140	20	4,3	176,5	31,5	1,9	157	158	1.100	1846.32
140	25	4,3	176,5	31,5	1,9	157	158	0.850	1846.32
140	32	4,3	176,5	31,5	2,4	157	158	0.860	1846.32
140	63	4,3	182.0	50.0	3.0	150	210	1.594	1846.32
160	20	4,9	187,5	31.0	1,9	178	158	1.450	2709.56
160	25	4,9	187,5	31.0	1,9	178	158	1.490	2709.56
160	32	4,9	187,5	31.0	2,4	178	158	1.485	2709.56
225	140	6,9	226.0	40.0	4,3	295	270	9.100	8003.46
225	160	4,9	227,5	39.0	4,9	275	280	9.795	8003.46



stomplasmafittings - IR
raccords pour le soudage bout à bout - IR
fittings for butt welding - IR

PVDF-SOLEF®

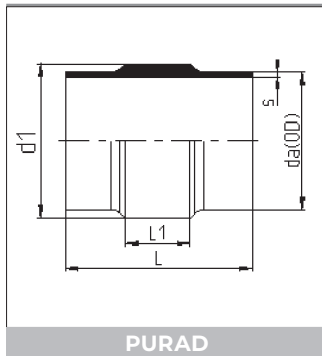

PURAD

INSTRUMENT FITTINGEN
RACCORD INSTRUMENT
INSTRUMENTATION FITTING

da	L	L1	d1	SDR 21 / ISO S-10			SDR 33 / ISO S-16		
				s	KG/ST/PC	€/ST/PC	s	KG/ST/PC	€/ST/PC
*20	120	50	50	1.9	0.193	106.18			
*25	120	50	55	1.9	0.262	119.10			
*32	120	50	60	2.4	0.273	145.46			
*40	120	50	75	2.4	0.416	180.86			
*50	120	50	80	3.0	0.451	227.20			
63	120	52	84	3.0	0.410	248.22			
*75	120	50	105	3.6	0.633	800.23			
90	149	60	105	4.3	0.719	334.75	2.8	0.55	321.66
110	150	60	124	5.3	0.811	419.73	3.4	0.69	404.75
125	160	80	143	6.0	1.240	639.80	3.9	1.02	591.90
140	158	78	157	6.7	1.470	736.18	4.3	1.25	712.50
160	158	78	178	7.7	1.820	895.05	4.9	1.51	859.33
*200	120	50	224	9.6	3.480	1510.32	6.2	2.78	1510.32
*225	130	50	246	10.8	2.569	1808.69	6.9	1.93	1808.69
*250	140	50	285	11.9	3.380	3245.61	7.7	2.81	3245.61
*280	140	50	298	13.4	3.420	3355.43	8.6	2.70	3355.43

* machined

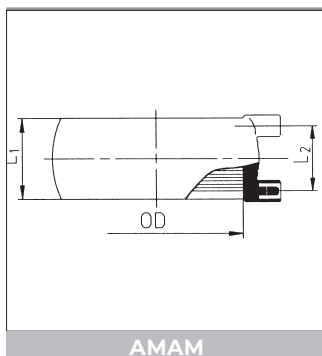

AMAM

ELECTROLASMOFFEN
MANCHONS ELECTRO-SOUDAGE
ELECTRO-WELDING SLEEVES

Gespoten / Injectés / Moulded.

SDR 21 / ISO S-101

da	L1	L2	KG/ST/PC	€/ST/PC
20	20.0	15	0.018	22.49
25	20.0	15	0.019	23.24
32	20.5	15	0.022	25.71
40	25.0	20	0.035	27.99
50	30.0	24	0.048	29.90
63	30.0	24	0.061	38.51

Te lassen met lasapparaat AGRU EF 110B / Pour souder avec souder AGRU EF 110B /
To weld with welding machine AGRU EF 110B



stomplasmafittings - IR
raccords pour le soudage bout à bout - IR
fittings for butt welding - IR

PVDF-SOLEF®

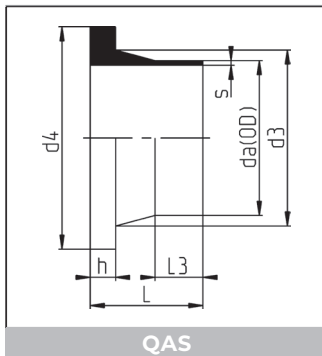

GESPOTEN VOORLASKRAGEN
COLLETS INJECTES
MOULDED STUBS

Gespoten. / Injectés. / Moulded.

da	d3	d4	L	SDR 33 / ISO S-16				SDR 21 / ISO S-10					
				s	L3	h	KG ST/PC	€ ST/PC	s	L3	h	KG ST/PC	€ ST/PC
20	27	45	50					1.9	31.0	6.0	0.029	8.01	
25	33	58	50					1.9	30.0	6.5	0.044	9.32	
32	40	68	50					2.4	26.0	7.0	0.065	12.47	
40	50	78	50					2.4	24.0	8.0	0.080	17.78	
50	61	88	50					3.0	22.0	9.0	0.126	23.92	
63	76	102	50					3.0	19.5	10.0	0.174	34.76	
75	89	122	50					3.6	20.0	10.0	0.238	69.32	
90	105	138	80	2.8	42	11	0.355	88.32	4.3	42.0	11.0	0.406	93.73
110	125	158	80	3.4	42	12	0.457	124.78	5.3	40.0	12.0	0.537	130.71
125	132	158	80	3.9	33	14	0.459	187.48	6.0	42.0	14.0	0.612	245.25
140	155	188	80	4.3	41	15	0.663	295.63	6.7	42.0	15.0	0.810	401.94
160	175	212	80	4.9	37	16	0.937	384.59	7.7	36.5	16.0	1.073	519.28
180	183	212	80	5.5	57	18	0.795	487.61	8.6	57.0	18.0	1.040	663.37
200	232	268	98	6.2	42	18	1.870	649.55	9.6	43.0	20.0	2.260	883.18
225	235	268	100	6.9	76	18	1.450	692.83	10.8	76.0	20.0	1.955	942.39
250	285	320	100	7.7	40	20	2.740	833.13	11.9	39.0	22.0	3.330	1255.63
280	288	320	100	8.6	50	20	2.320	1027.83	13.4	72.0	25.0	3.060	1652.88
315	335	370	102	9.7	44	20	3.160	1236.92					

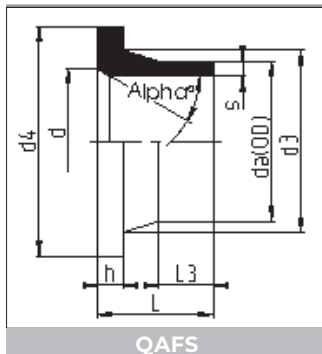

VOORLASKRAGEN VOOR VLINDERKLEPPEN
COLLERETTE CHANFREINEE POUR ROBINETS D'ARRÊT
CHAMFERED STUB END

SDR 21 / ISO S-10

da	s	L	L3	d	d3	d4	h	Alpha°	KG/ST/PC	€/ST/PC
140	6.7	80	42.0	130	155	188	15	30	0.824	403.94
160	7.7	81	36.5	150	175	212	16	30	1.017	519.28
180	8.6	80	57.0	150	183	212	18	30	1.102	663.37
200	9.6	98	43.0	210	232	268	20	30	2.052	883.18
225	10.8	100	76.0	210	235	268	20	30	1.850	942.39
250	11.9	100	35.0	255	285	320	22	25	3.460	1255.63
280	13.4	100	48.5	255	288	320	25	25	3.130	1652.88
315	15.0	102	41.0	308	335	370	25	30	3.300	1998.60

OVERSCHUIFFLENZEN MET STALEN KERN PP-GFK
BRIDES LIBRES AVEC NOYAU EN ACIER PP-GFK
BACKING FLANGES WITH STEEL INSERT PP-GFK

Zie hoofdstuk Flenzen / Voir chapitre Brides / See chapter Flanges

PVDF BLINDFLENZEN DRUKLOZE TOEPASSINGEN
BRIDES PLEINES EN PVDF APPLICATIONS SANS PRESSION
PVDF BLINDFLANGES NO PRESSURE APPLICATIONS

Volgens DIN-norm. boring PN 10. / Selon norme DIN. forage PN 10. / According to DIN. drilled PN 10.
Op aanvraag leverbaar / livrable sur demande / available on request



stomplasmafittings - IR
raccords pour le soudage bout à bout - IR
fittings for butt welding - IR

PVDF-SOLEF®

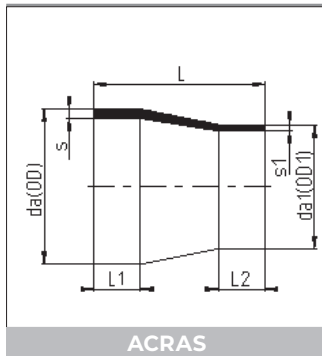

CONCENTRICHE VERLOOPSTUKKEN, VERLENGD
REDUCTIONS CONCENTRIQUES, ALLONGES
CONCENTRIC REDUCERS, ELONGATED

Gespoten.
Injectés.
Moulded.

da/da1	L	L1	L2	SDR 33 / PN 10 / S-16				SDR 21 / PN 16 / S-10					
				s	s1	KG	€	s	s1	KG	€		
				ST/PC	ST/PC	ST/PC	ST/PC	ST/PC	ST/PC	ST/PC	ST/PC	ST/PC	ST/PC
25/20	50	20.0	20					1.9	1.9	0.01	12.53		
32/20	50	18.5	19					2.4	1.9	0.02	16.79		
32/25	50	20.0	20					2.4	1.9	0.02	16.79		
40/20	55	20.0	20					2.4	1.9	0.02	20.98		
40/25	55	20.0	20					2.4	1.9	0.02	20.98		
40/32	55	20.0	20					2.4	2.4	0.03	22.42		
50/20	60	23.0	20					3.0	1.9	0.04	23.53		
50/25	60	24.0	20					3.0	1.9	0.04	24.70		
50/32	60	25.0	20					3.0	2.4	0.04	24.70		
50/40	60	25.0	22					3.0	2.4	0.05	24.70		
63/25	75	25.0	20					3.0	1.9	0.06	35.69		
63/32	65	25.0	18					3.0	2.4	0.06	35.69		
63/40	65	26.0	22					3.0	2.4	0.06	35.69		
63/50	65	25.0	24					3.0	3.0	0.07	35.69		
75/40	80	-	-					3.6	2.4	0.10	69.64		
75/50	80	63.0	57					3.6	3.0	0.10	69.64		
75/63	80	65.0	60					3.6	3.0	0.11	69.64		
90/50	80	30.0	25					4.3	3.0	0.14	90.06		
90/63	80	70.0	59					4.3	3.0	0.15	90.06		
90/75	80	75.0	62					4.3	3.6	0.16	91.02		
110/63	103	30.0	33					5.3	3.0	0.24	108.85		
110/75	95	33.0	33					5.3	3.6	0.26	110.66		
110/90	90	30.0	35	3.4	2.8	0.20	110.66	5.3	4.3	0.25	110.66		
140/63	133	38.0	27	-	-	-	-	6.7	3.0	0.50	180.68		
140/110	110	42.0	40	4.3	3.4	0.39	180.68	6.7	5.3	0.50	180.68		
160/110	121	95.0	89	4.9	3.4	0.82	246.88	7.7	5.3	1.21	283.91		
160/140	121	95.0	96	4.9	4.3	0.92	327.09	7.7	6.7	1.43	376.20		
225/160	160	32.0	35	6.9	4.9	1.15	799.43	10.8	7.7	1.68	799.43		
250/160	179	36.0	36	7.7	4.9	1.54	858.27	11.9	7.7	2.25	858.27		
250/225	180	43.0	28	7.7	6.9	1.85	918.74	11.9	10.8	2.69	1044.65		
315/160	180	42.0	37	9.7	4.9	2.29	1302.06						
315/250	180	42.0	37	9.7	7.7	2.57	1327.80						

Andere diameters : op aanvraag
Autres diamètres : sur demande
Other diameters : on request



stomplasmafittings
raccords pour le soudage bout à bout
fittings for butt welding

PVDF-SOLEF®

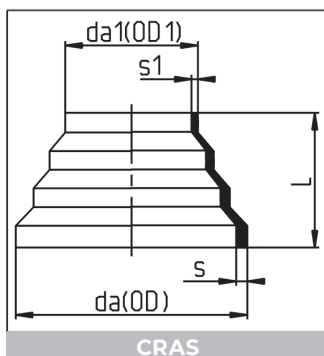

CONCENTRISCHE VERLOOPSTUKKEN
REDUCTIONS CONCENTRIQUES
CONCENTRIC REDUCERS

Gespoten.
Injectés.
Moulded.

da x da ¹	L	L1	L2	SDR 33 / ISO S-16			SDR 21 / ISO S-10				
				S	S1	KG €	S	S1	KG €		
				ST/PC	ST/PC		ST/PC	ST/PC			
63 x 16	56	9	5				3.0	1.9	0.039	31.14	
110 x 63	65	11	7	3.4	2.5	0.127	71.42	5.3	3.0	0.147	92.88
160 x 110	85	14	13	4.9	3.4	0.326	197.63				
225 x 160	97	20	14	6.9	4.9	0.788	295.63				
315 x 225	137	26	19	9.7	6.9	2.024	540.19				



stomplasfittings - IR
raccords pour le soudage bout à bout - IR
fittings for butt welding - IR

PVDF-SOLEF®

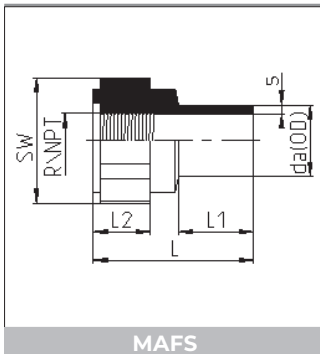

MAFS

OVERGANGSSTUKKEN
EMBOUTS D'ADAPTATION
ADAPTOR COUPLINGS

Gespoten. GFK versterkt.

Vrouwelijke draadaansluiting standaard volgens BS-norm, NPT-draad op aanvraag.
Alleen geschikt voor kunststof draadverbindingen.

Injectés. Renforcé fibre de verre

Fixation fileté femelle standard selon norme BS, filetage NPT sur demande.
Uniquement pour des connexions matières synthétiques.

Moulded. Glassfiber reinforced

One end female threaded (standard thread BS, also available with NPT thread).
Only for plastic threaded connections.

SDR21 / ISO S-10

da	s	L	L1	L2	SW	R	KG/ST/PC	€/ST/PC
20	1,9	46	20	16	32	½"	0,026	15.15
25	1,9	51	23	18	41	¾"	0,047	17.61
32	2,4	58	29	20	46	1"	0,058	26.06
40	2,4	62	30	24	55	1¼"	0,089	30.72
50	3,0	68	34	24	70	1½"	0,166	47.94
63	3,0	75	35	28	85	2"	0,250	66.80

NPT op aanvraag / sur demande / on request

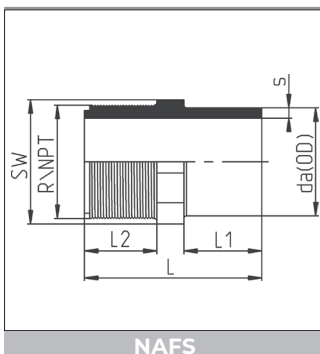

NAFS

OVERGANGSSTUKKEN
EMBOUTS D'ADAPTATION
ADAPTOR COUPLINGS

Gespoten.

Mannelijke draadaansluiting standaard volgens BS-norm, NPT-draad op aanvraag.
Alleen geschikt voor kunststof draadverbindingen.

Injectés.

Fixation fileté male standard selon norme BS, filetage NPT sur demande.
Uniquement pour des connexions matières synthétiques.

Moulded.

One end male threaded (standard thread BS, also available with NPT thread).
Only for plastic threaded connections.

SDR21 / ISO S-10

da	s	L	L1	L2	SW	R	KG/ST/PC	€/ST/PC
20	1,9	46	20	18	22	½"	0,014	13.02
25	1,9	51	23	20	27	¾"	0,020	15.15
32	2,4	61	29	23	36	1"	0,041	23.12
40	2,4	66	29	27	46	1¼"	0,072	28.10
50	3,0	74	33	29	55	1½"	0,090	42.84
63	3,0	80	35	31	65	2"	0,128	54.65

NPT op aanvraag / sur demande / on request



stomplasmafittings - IR
raccords pour le soudage bout à bout - IR
fittings for butt welding - IR

PVDF-SOLEF®

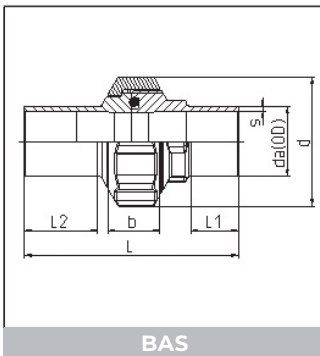

BAS

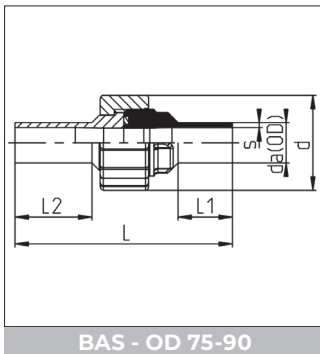

BAS - OD 75-90

DRIEDELIGE KOPPELINGEN
RACCORDS UNION
SOCKET UNIONS

Gespoten. Met dichting in FPM.
Injectés. Avec fermeture en FPM.
Moulded. Sealing: O-ring in FPM.

SDR 21 / ISO S-10

OD	s	L	L1	L2	d	b	KG/ST/PC	€/ST/PC
20	1.9	106	27	38	43	23.0	0.063	52.31
25	1.9	112	27	40	53	25.0	0.101	59.02
32	2.4	120	27	44	60	27.0	0.130	86.92
40	2.4	124	27	47	75	30.0	0.217	123.28
50	3.0	132	27	47	82	35.0	0.297	134.81
63	3.0	137	27	47	100	37.5	0.422	185.82
* 75	3.6	132	28	47	130	40.0	0.759	261.16
* 90	4.3	130	34	55	130	40.0	0.730	333.52

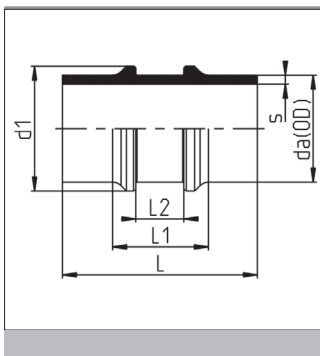

VASTE PUNTEN
POINTS FIXES
FIXED POINTS

Gespoten / injecté / moulded.

da	L	L1	L2	d1	SDR 33 / ISO S-16			SDR 21/ ISO S-10		
					s	KG/ST/PC	€/ST/PC	S	KG/ST/PC	€/ST/PC
32	120	68	33.0	40				2.4	0.070	35.87
63	120	68	30.0	71				3.0	0.170	75.52
90	150	75	40.0	104	2.8	0.333	175.40	4.3	0.420	185.76
110	150	77	40.0	126	3.4	0.470	259.82	5.3	0.630	275.72
125	160	98	60.5	143	3.9	0.620	390.95	6.0	0.853	407.17
140	160	100	60.5	160	4.3	0.826	461.42	6.7	1.050	484.01
160	160	100	60.0	178	4.9	1.040	595.03	7.7	1.340	623.16



stomplasfittings - IR
raccords pour le soudage bout à bout - IR
fittings for butt welding - IR

PVDF-SOLEF®

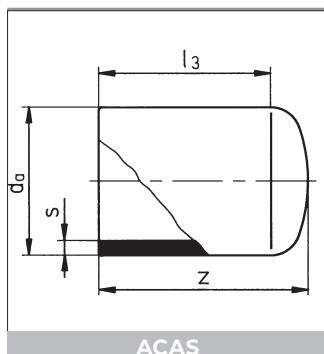

ACAS

EINDKAPPEN VERLENGD
BOUCHONS ALLONGES
END CAPS ELONGATED

Gespoten.
Injectés.
Moulded.

da	z	SDR 33 / ISO S-16			SDR 21 / ISO S-10				
		s	L3	KG/ST/PC	€/ST/PC	s	L3	KG/ST/PC	€/ST/PC
20	48					1.9	41	0.011	12.20
25	48					1.9	41	0.013	13.93
32	52					2.4	42	0.024	15.72
40	60					2.4	48	0.039	28.99
50	64					3.0	48	0.070	35.37
63	69					3.0	50	0.086	56.75
75	93					3.6	75	0.168	70.07
90	110	2.8	84	0.198	57.26	4.3	84	0.277	74.90
110	125	3.4	90	0.310	74.28	5.3	99	0.463	107.57

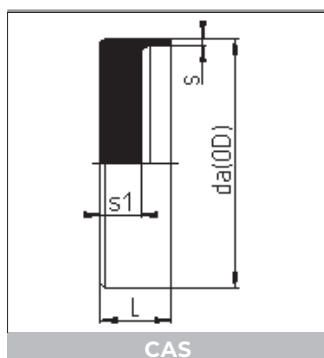

CAS

EINDKAPPEN
BOUCHONS
END CAPS

Uit plaat gedraaid
Tournés hors de plaque
Machined from plate

OD	L	S1	SDR 33 / ISO S-16			SDR 21 / ISO S-10		
			s	KG/ST/PC	€/ST/PC	s	KG/ST/PC	€/ST/PC
125	35	20	3.9	0.507	157.33	6.0	0.540	219.72
140	35	20	4.3	0.623	250.38	6.7	0.800	268.09
160	35	20	4.9	0.785	288.25	7.7	0.856	315.85
200	35	20	6.2	1.265	407.69	9.6	1.312	450.18
225	35	20	6.9	1.533	477.45	10.8	1.460	504.47



stomplasmafittings + IR
raccords pour le soudage bout à bout + IR
fittings for butt welding + IR

PVDF-SOLEF®

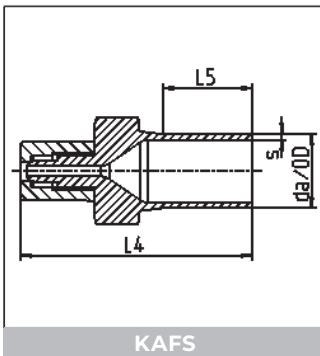

OVERGANGSSTUKKEN
EMBOUTS D'ADAPTATION
ADAPTOR COUPLINGS

van PVDF naar PFA, Flare Link
du PVDF au PFA, Flare Link
PVDF to PFA, Flare Link

SDR 21 - MOP 10 bar

da x R	s	L4		KG/ST/PC	€/ST/PC
20 x 1/4"	1,9	78.0	30	0.029	*120.31
20 x 3/8"	1,9	79.0	30	0.034	*128.03
20 x 1/2"	1,9	80,5	30	0.034	*159.65
20 x 3/4"	1,9	84.0	30	0.051	*159.15
25 x 1/4"	1,9	78.0	30	0.042	*128.03
25 x 3/8"	1,9	79.0	30	0.047	*139.73
25 x 1/2"	1,9	80,5	30	0.044	*151.41
25 x 3/4"	1,9	84.0	30	0.056	*174.63
25 x 1"	1,9	93,5	30	0.120	*197.97
32 x 1/2"	2,4	80,5	30	0.070	*178.57
32 x 3/4"	2,4	84.0	30	0.075	*197.97
32 x 1"	2,4	93,5	30	0.113	*225.05
40 x 1/2"	2,4	80,5	30	0.080	*201.81
40 x 3/4"	2.4	84.0	30	0.091	*290.49

* PURAD



moflasfittings
raccords pour le soudage dans l'emboîture
fittings for socket welding

PVDF-SOLEF®

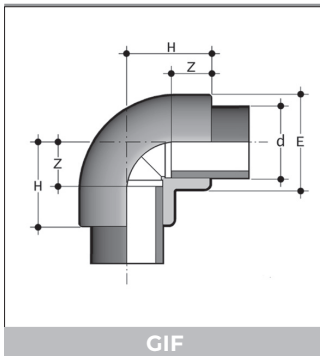

GIF

KNIEEN 90°
COUDES 90°
ELBOWS 90°

Gespoten PN 16.
Injectés PN 16.
Moulded PN 16.

D	Z	H	E	KG/ST/PC	€/ST/PC
16	10.0	23.0	21.5	0.014	9.35
20	12.5	27.0	27.5	0.028	10.70
25	15.5	31.5	33.0	0.043	13.21
32	18.5	36.5	41.0	0.065	27.45
40	22.5	43.0	51.5	0.125	44.07
50	27.0	50.5	62.5	0.195	65.37
63	33.5	61.0	77.0	0.340	110.75
75	42.0	73.0	92.0	0.575	190.01
90	47.0	83.0	109.5	0.850	281.61
110	57.5	99.0	133.0	1.470	517.63

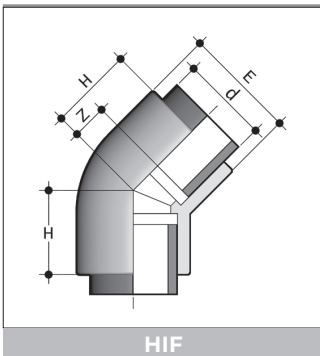

HIF

KNIEEN 45°
COUDES 45°
ELBOWS 45°

Gespoten PN 16.
Injectés PN 16.
Moulded PN 16.

D	Z	H	E	KG/ST/PC	€/ST/PC
20	7.0	21.5	27.5	0.024	12.58
25	9.0	25.0	33.7	0.037	18.35
32	11.5	29.5	41.5	0.063	21.49
40	16.0	36.5	51.0	0.110	36.08
50	19.0	42.5	62.5	0.202	40.02
63	24.5	52.0	78.5	0.337	64.57
75	30.0	61.0	88.0	0.395	160.25
90	37.0	72.5	105.0	0.645	243.55
110	45.5	87.0	127.0	1.095	433.89



moflasfittings
raccords pour le soudage dans l'emboîture
fittings for socket welding

PVDF-SOLEF®

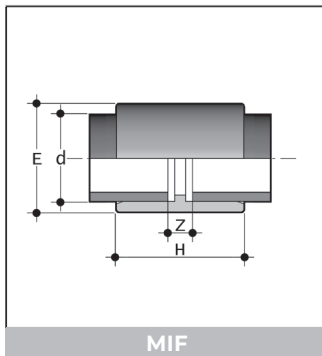

SOKKEN
MANCHONS
SOCKETS

Gespoten PN 16.
Injectés PN 16.
Moulded PN 16.

D	Z	H	E	KG/ST/PC	€/ST/PC
20	7.0	36.0	27.5	0.020	7.73
25	8.0	40.0	33.0	0.028	9.13
32	8.0	44.0	41.6	0.048	12.38
40	7.5	48.5	50.8	0.070	18.67
50	8.0	55.0	62.8	0.120	55.03
63	9.0	64.0	76.7	0.185	79.10
75	9.5	71.5	90.0	0.275	83.19
90	8.0	79.0	108.0	0.415	128.65
110	10.5	93.5	130.7	0.710	237.90

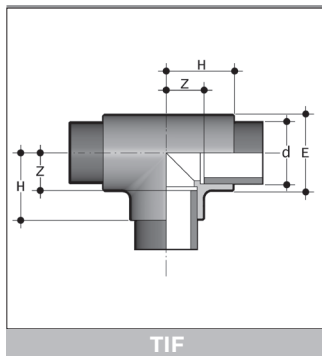

T-STUKKEN 90°
TES A 90°
TEES 90°

Gespoten PN 16.
Injectés PN 16.
Moulded PN 16.

D	Z	H	E	KG/ST/PC	€/ST/PC
16	10.0	23.0	21.5	0.018	17.70
20	12.5	27.0	27.5	0.035	18.67
25	15.5	31.5	33.0	0.055	22.87
32	18.5	36.5	41.0	0.090	34.01
40	22.0	42.5	51.0	0.150	52.88
50	28.5	52.0	63.0	0.270	80.68
63	35.0	62.5	78.5	0.470	126.74
75	39.5	70.5	92.5	0.665	239.80
90	46.0	81.5	108.5	1.025	361.63
110	58.0	99.0	132.5	1.800	663.74



moflasfittings
raccords pour le soudage dans l'emboîture
fittings for socket welding

PVDF-SOLEF®

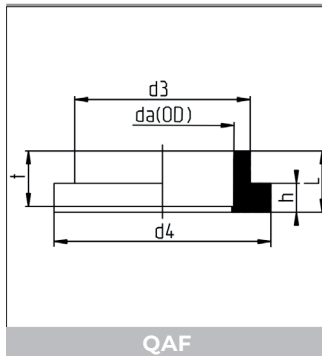

KRAAGBUSSEN
COLLETS A JOINT PLATS
FLAT-SEATED STUBS

Gespoten PN 16.
Injectés PN 16.
Moulded PN 16.

d	L	d3	d4	h	t	KG/ST/PC	€/ST/PC
16	20	27	45	6	15	0.03	9.01
20	21	27	45	6	16	0.02	9.36
25	22	33	58	7	17	0.04	10.87
32	25	41	68	7	20	0.05	13.24
40	26	50	78	8	21	0.07	21.45
50	30	61	88	8	25	0.10	29.17
63	33	76	122	9	28	0.14	37.49
75	37	90	120	10	32	0.23	94.19
90	41	109	125	11	36	0.32	127.38
110	48	131	150	12	43	0.46	177.62

OVERSCHUIFFLENZEN MET STALEN KERN / PP-GFK
BRIDES LIBRES AVEC NOYEAU EN ACIER / PP-GFK
BACKING FLANGES WITH STEELINSERT / PP-GFK

Zie hoofdstuk Flenzen
Voir chapitre Brides
See chapter Flanges



moflasfittings
raccords pour le soudage dans l'emboîture
fittings for socket welding

PVDF-SOLEF®

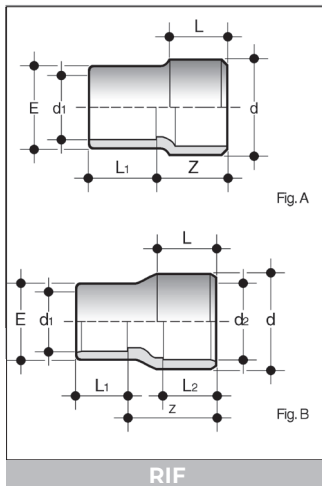

CONCENTRISCHE VERLOOPSTUKKEN
REDUCTIONS CONCENTRIQUES
CONCENTRIC REDUCERS

Gespoten PN 16.
Injectés PN 16.
Moulded PN 16.

D x D ₁	z	L1	E	TYPE	KG/ST/PC	€/ST/PC
20 x 16	22.0	35.0	20.0	A	0.011	11.06
25 x 16	25.0	40.0	24.0	B	0.020	15.41
25 x 20	25.5	40.0	26.0	A	0.015	13.05
32 x 20	29.0	44.0	29.0	B	0.031	22.36
32 x 25	30.0	46.0	31.5	A	0.028	17.48
40 x 20	34.0	48.0	29.0	B	0.043	25.15
40 x 25	35.0	51.0	32.0	A	0.040	21.38
40 x 32	35.5	53.5	39.5	A	0.047	24.13
50 x 20	39.0	55.0	29.0	B	0.064	30.85
50 x 25	37.0	55.0	35.0	B	0.067	30.85
50 x 32	41.0	59.0	39.0	A	0.055	25.98
50 x 40	42.5	63.0	47.0	A	0.070	30.42
63 x 25	47.0	65.0	35.0	B	0.107	45.70
63 x 32	49.0	67.0	40.0	A	0.100	36.52
63 x 40	43.0	65.0	53.0	B	0.126	46.22
63 x 50	52.5	76.0	59.5	A	0.130	38.73
75 x 63	61.0	88.5	75.0	A	0.220	80.68
90 x 63	69.5	97.0	73.0	A	0.280	87.88
90 x 75	72.5	103.5	86.5	A	0.335	87.88
110 x 63	61.0	88.0	81.0	B	0.467	151.42
110 x 90	85.0	120.5	102.5	A	0.520	132.69

Type B : AGRU

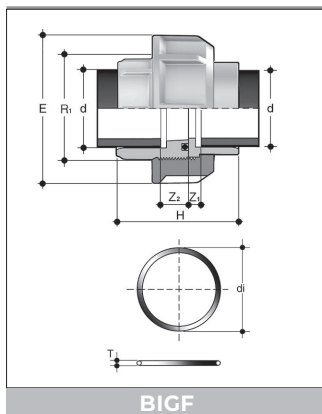

DRIEDELIGE KOPPELINGEN
RACCORDS UNION
SOCKET UNIONS

Gespoten PN 16. Met O-ring in FPM.
Injectés PN 16, avec bague O en FPM.
Moulded PN 16, with O-ring in FPM.

D	R1	Z ₁	Z ₂	H	E	€/ST/PC
20	1"	12	5.5	45.5	47	33.88
25	1 1/4"	12	5.5	49.5	58	45.68
32	1 1/2"	12	5.5	53.5	65	55.44
40	2"	14	5.5	59.5	78	79.10
50	2 1/4"	16	5.5	67.5	85	110.10
63	2 3/4"	20	5.5	79.5	103	166.35



moflasfittings
raccords pour le soudage dans l'emboîture
fittings for socket welding

PVDF-SOLEF®

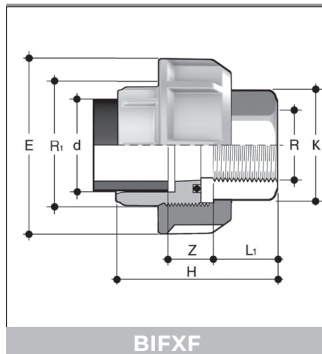

DRIEDELIGE KOPPELINGEN
RACCORDS D'ADAPTATION 3 PIECES
SOCKETS UNIONS

Inlegstuk: PVDF met lasmof
Puntstuk: RVS A316L BS met parallel binnendraad
Wartelmoer: PVDF
Afdichting: O-ring FPM

Pièce folle: PVDF, côté femelle à souder
Pièce taraudée: INOX A316L BS, femelle à filetage pararell
Ecrou: PVDF
Etanchéité: joint torique FPM

Insert: PVDF, socket for socket welding
Close end: Stainless Steel A316L BS with parallel female threaded
Union nut: PVDF
Sealing: O-ring FPM

d x R	R ₁	PN	L1	Z	H	K	E	€/ST/PC
20 x 1/2"	1"	16	16.5	18.0	48.5	25	47	153.36
25 x 3/4"	1 1/4"	16	18.5	19.0	53.5	32	58	227.00
32 x 1"	1 1/2"	16	19.5	20.0	57.5	38	65	279.80
40 x 1 1/4"	2"	16	21.5	23.0	64.5	48	78	381.47
50 x 1 1/2"	2 1/4"	16	23.0	32.5	78.5	55	85	407.69
63 x 2"	2 3/4"	16	27.0	31.5	85.5	69	103	474.27

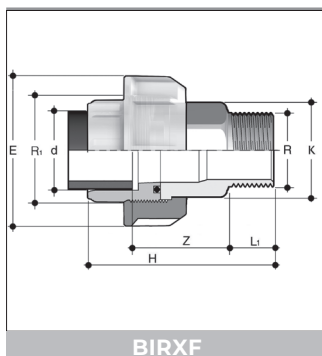

DRIEDELIGE KOPPELINGEN
RACCORDS D'ADAPTATION 3 PIECES
SOCKETS UNIONS

Inlegstuk: PVDF met lasmof
Puntstuk: RVS A316L BS met parallel buitendraad
Wartelmoer: PVDF
Afdichting: O-ring FPM

Pièce folle: PVDF, côté femelle à souder
Pièce taraudée: INOX A316L BS, mâle à filetage pararell
Ecrou: PVDF
Etanchéité: joint torique FPM

Insert: PVDF, socket for socket welding
Close end: Stainless Steel A316L BS with parallel male threaded
Union nut: PVDF
Sealing: O-ring FPM

d x R	R ₁	PN	L1	Z	L	H	K	E	€/ST/PC
20 x 1/2"	1"	16	13.5	37.5	16	65.0	25	47	172.59
25 x 3/4"	1 1/4"	16	15.0	40.5	19	71.5	32	58	253.07
32 x 1"	1 1/2"	16	17.5	42.5	22	78.0	38	65	321.00
40 x 1 1/4"	2"	16	19.5	47.5	26	87.0	48	78	467.99
50 x 1 1/2"	2 1/4"	16	19.5	52.5	31	95.0	55	85	477.06
63 x 2"	2 3/4"	16	24.0	62.5	38	113.5	69	103	550.98



moflasfittings
raccords pour le soudage dans l'emboîture
fittings for socket welding

PVDF-SOLEF®

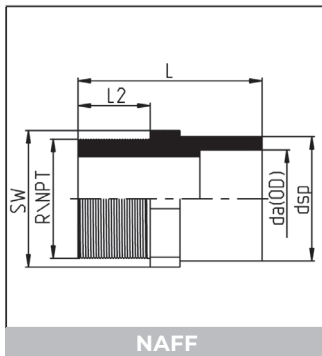

OVERGANGSSTUKKEN
EMBOUTS D'ADAPTATION
ADAPTOR COUPLINGS

Gespoten PN 10.

Mannelijke draadaansluiting standaard met BS-draad, NPT-draad op aanvraag.

Injectés PN 10.

Fixation fileté mâle standard BS, filetage NPT sur demande.

Moulded PN 10.

One end male threaded standard BS, NPT on request.

da	R	d _{sp}	L	t	L ₂	SW	KG/ST/PC	€/ST/PC
20	3/4"	25 ^{+0,6}	51 ^{±4}	17,2	20 ^{±2}	29,5 ^{±3}	0,023	20.57
25	1"	32 ^{+0,6}	61 ^{±4}	19,5	24 ^{±2}	39,5 ^{±3}	0,049	31.44
32	1 1/4"	40 ^{+0,8}	66 ^{±4}	21,5	27 ^{±2}	45,5 ^{±3}	0,072	38.19
40	1 1/2"	50 ^{+1,0}	74 ^{±4}	24,0	29 ^{±2}	60,0 ^{±3}	0,119	58.20
50	2"	63 ^{+1,2}	78 ^{±4}	29,0	31 ^{±2}	71,0 ^{±3}	0,177	74.28

NPT op aanvraag / sur demane / on request

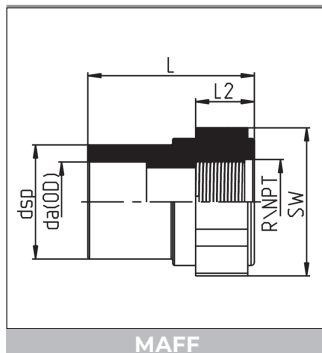

OVERGANGSSTUKKEN
EMBOUTS D'ADAPTATION
ADAPTOR COUPLINGS

Gespoten PN 10. GFK versterkt

Vrouwelijke draadaansluiting standaard met BS-draad, NPT-draad op aanvraag.

Injectés PN 10. Renforcé fibre de verre.

Fixation fileté femelle standard BS, filetage NPT sur demande.

Moulded PN 10. Glassfiber reinforced.

One end female threaded standard BS, NPT on request.

da	R	d _{sp}	L	t	L ₂	SW	KG/ST/PC	€/ST/PC
20	1/2"	29,5	45,0 ^{±4}	14,5	16 ^{±2}	32	0,037	22.19
25	3/4"	35,0	50,5 ^{±4}	16,0	18 ^{±2}	41	0,059	29.66
32	1"	42,5	57,0 ^{±4}	18,1	20 ^{±2}	46	0,094	38.63
40	1 1/4"	52,0	62,5 ^{±4}	20,5	24 ^{±2}	55	0,146	53.45
50	1 1/2"	64,0	68,0 ^{±4}	23,5	26 ^{±2}	70	0,236	72.57
63	2"	80,0	74,0 ^{±4}	27,4	30 ^{±2}	85	0,396	99.01



moflasfittings
raccords pour le soudage dans l'emboîture
fittings for socket welding

PVDF-SOLEF®

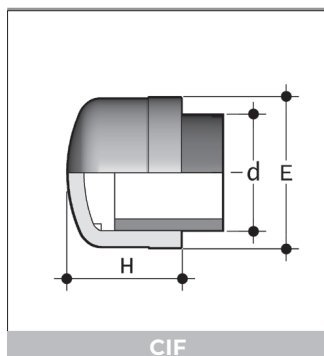

AFSLUITKAPPEN
BOUCHONS FEMELLES
END CAPS

Gespoten PN 16
Injectés PN 16
Moulded PN 16

D	H	E	KG/ST/PC	€/ST/PC
20	22.5	27.5	0.011	13.21
25	27.0	33.0	0.019	14.45
32	31.0	41.0	0.032	16.63
40	36.0	50.0	0.047	31.69
50	42.5	60.5	0.075	37.32
63	51.0	75.5	0.135	60.18
75	58.0	89.5	0.215	63.16
90	68.0	108.5	0.400	78.19
*110	81.0	130.0	0.630	202.34

* AGRU



kranen
vannes
valves

DUAL BLOCK®

PVDF-SOLEF®

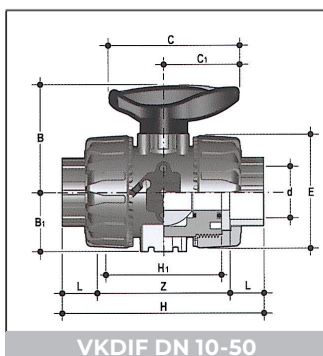

VKDIF DN 10-50

KOGELKRANEN
VANNES A BILLE
BALL VALVES

PN 16

2-Wegkogelafsluiter, Dual Block® met inwendige lasmoffen.
Zittingen PTFE/EPDM, PTFE/FPM.

Robinets à bille Dual Block® tournant sphérique à 2 voies. Avec embouts femelles à souder.
Sièges PTFE/EPDM, PTFE/FPM.

2-Way ball valve Dual Block® with lockable nuts, welding sockets.
Seats PTFE/EPDM, PTFE/FPM.

D	DN	Z	H	H1	E	B	B1	C	C1	G/ST/PC	€/ST/PC FPM
16	10	74.5	102	65	54	54.0	29.0	67	40	291	168.03
20	15	73.0	102	65	54	54.0	29.0	67	40	272	174.52
25	20	82.0	114	70	65	65.0	34.5	85	49	445	217.44
32	25	90.0	126	78	73	69.5	39.0	85	49	584	279.05
40	32	100.0	141	88	86	82.5	46.0	108	64	938	361.30
50	40	117.0	164	93	98	89.0	52.0	108	64	1242	520.59
63	50	144.0	199	111	122	108.0	62.0	134	76	2187	773.97
75	65	147.0	235	133	164	164.0	87.0	225	175	4380	2009.32
90	80	168.0	270	149	203	177.0	105.0	327	272	7200	2530.74
110	100	186.0	308	167	238	195.0	129.0	385	330	11141	3688.54

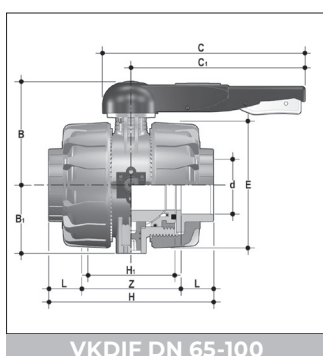

VKDIF DN 65-100

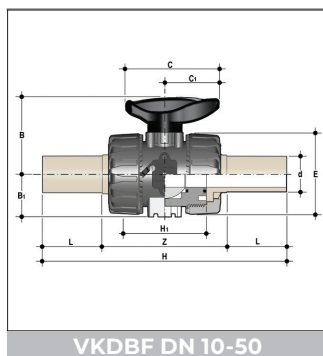

VKDBF DN 10-50

KOGELKRANEN
VANNES A BILLE
BALL VALVES

PN 16

2-Wegkogelafsluiter, Dual Block® met verlengde mannelijke laseinden PVDF voor spiegelass / IR las.
Zittingen PTFE/EPDM, PTFE/FPM.

Robinets à bille Dual Block® tournant sphérique à 2 voies. Embouts mâles longues PVDF pour soudage bout à bout / IR.
Sièges PTFE/EPDM, PTFE/FPM.

2-Way ball valve Dual Block® with lockable nuts, with long spigot male ends PVDF for butt welding / IR welding.
Seats PTFE/EPDM, PTFE/FPM.

D	DN	Z	H	H1	E	B	B1	C	C1	L	G ST/PC	€ ST/PC FPM
20	15	94	175	65	54	54	29	67	40	40.5	450	260.28
25	20	106	212	70	65	65	35	85	49	54.0	516	325.50
32	25	117	226	78	73	70	39	85	49	56.0	664	412.13
40	32	131	246	88	86	83	46	108	64	56.0	1020	520.50
50	40	145	271	93	98	89	52	108	64	60.5	1350	759.13
63	50	161	300	111	122	108	62	134	76	65.5	2330	1127.74
75	65	214	356	133	162	164	87	225	175	71.0	4700	2799.64
90	80	214	390	149	202	177	105	327	272	88.0	7150	3526.15
110	100	247	431	167	236	195	129	385	330	92.0	11300	5139.41

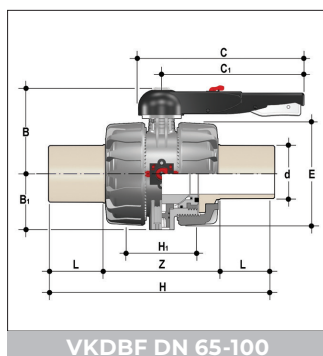

VKDBF DN 65-100



kranen
vannes
valves

DUAL BLOCK®

PVDF-SOLEF®

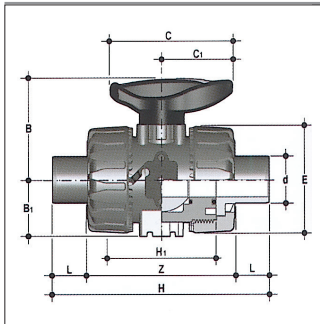

VKDDF DN 15-50

KOGELKRANEN
VANNES A BILLE
BALL VALVES

PN 16

2-Wegkogelafsluiter, Dual Block® met uitwendige lasmoffen.
Zittingen PTFE/EPDM, PTFE/FPM.

Robinets à bille Dual Block® tournant sphérique à 2 voies. Avec embouts mâles à souder.
Sièges PTFE/EPDM, PTFE/FPM.

2-Way ball valve Dual Block® with lockable nuts, welding spigots.
Seats PTFE/EPDM, PTFE/FPM.

D	DN	L	H	H1	E	B	B1	C	C1	G/ST/PC	€/ST/PC FPM
20	15	16	124	65	54	54.0	29.0	67	40	299	205.31
25	20	19	144	70	65	65.0	34.5	85	49	466	256.76
32	25	22	154	78	73	69.5	39.0	85	49	604	325.10
40	32	26	174	88	86	82.5	46.0	108	64	951	410.57
50	40	31	194	93	98	89.0	52.0	108	64	1284	598.82
63	50	38	224	111	122	108.0	62.0	134	76	2229	889.59
75	65	44	284	133	164	164.0	87.0	327	272	4420	2208.37
90	80	51	300	149	203	177.0	105.0	327	272	6930	2781.44
110	100	61	340	167	238	195.0	129.0	385	330	10950	4054.02

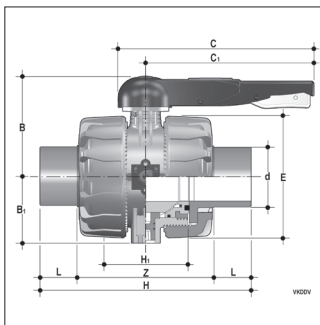

VKDDF DN 65-100

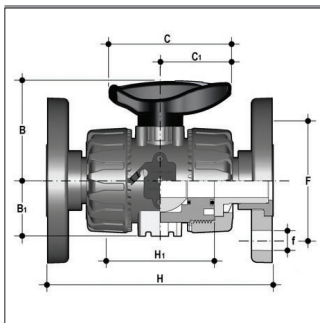

VKDOF DN 15-50

KOGELKRANEN
VANNES A BILLE
BALL VALVES

PN 16

2-Wegkogelafsluiter, Dual Block®, DIN 2501 vaste flenzen.
Inbouwlengte volgens EN 558-1.

Robinets à bille Dual Block® avec brides fixes, DIN 2501.
Encombrement selon EN 558-1.

2-Way ball valve Dual Block®, DIN 2501 fixed backing rings.
Face to face according EN 558-1.

D	DN	H	H1	B	B1	C	C1	F	f	U	G/ST/PC	€/ST/PC FPM
20	15	130	65	54.0	29.0	67	40	65	14	4	547	384.22
25	20	150	70	65.0	34.5	85	49	75	14	4	772	465.37
32	25	160	78	69.5	39.0	85	49	85	14	4	1024	600.98
40	32	180	88	82.5	46.0	108	64	100	18	4	1583	737.38
50	40	200	93	89.0	52.0	108	64	110	18	4	2024	1062.02
63	50	230	111	108.0	62.0	134	76	134	18	4	3219	1434.30
75	65	290	133	164.0	87.0	327	272	145	17	4	8588	2609.92
90	80	310	149	177.0	105.0	327	272	160	17	8	12122	3287.13
110	100	350	167	195.0	129.0	385	330	180	17	8	17949	4791.06

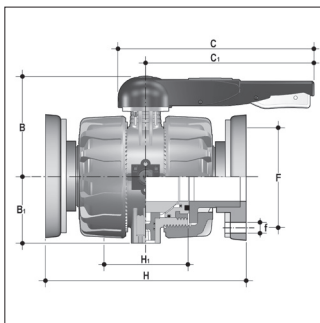

VKDOF DN 65-100



kranen
vannes
valves

DUAL BLOCK®

PVDF-SOLEF®

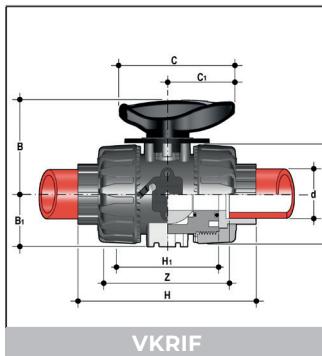

2 WEG KOGELKRANEN VOOR LINEAIRE DEBIETREGELING
VANNES A BILLE A 3 VOIES POUR REGULATION LINEAIRE DU DEBIT
2 WAY BALL VALVES FOR LINEAR FLOW CONTROL

Vrouwelijke lasmof.

Volledig uitwisselbaar met kogelkransen type VK Dual Block®.

Bereik: 0-90° / monodirectioneel. Met schaalverdeling per 5°.

Op aanvraag: elektrisch met posi 4-20mA / pneumatisch met klepstandsteller 4-20mA.

Bouts femelles à souder.

Complètement interchangeable avec les robinets à bille VK Dual Block®.

Portée: 0-90° / mono directionnel. Graduation visuelle par 5°.

Sur demande: actuateur électrique avec Posi 4-20mA / actuateur pneumatique avec positionneur 4-20mA.

Spigots for socket welding.

Complete interchangeability with VK Dual Block® series.

Range of use: 0-90° / unidirectional flow. Accuracy of the reading position 5°.

On request: electric actuator with Posi card 4-20mA / pneumatic actuator with positioner 4-20mA.

D	DN	PN	L	Z	H	H ¹	E	B	B ¹	C	C ¹	G/ST/PC	€/ST/PC FPM
16	10	16	14.0	74.5	102	65	54	54.0	29.0	67	40	291	344.83
20	15	16	14.5	73.0	102	65	54	54.0	29.0	67	40	272	351.40
25	20	16	16.0	82.0	114	70	65	65.0	34.5	85	49	445	400.35
32	25	16	18.0	90.0	126	78	73	69.5	39.0	85	49	584	484.85
40	32	16	20.5	100.0	141	88	86	82.5	46.0	108	64	938	591.39
50	40	16	23.5	117.0	164	93	98	89.0	52.0	108	64	1242	983.16
63	50	16	27.5	144.0	199	111	122	108.0	62.0	134	76	2187	1655.28

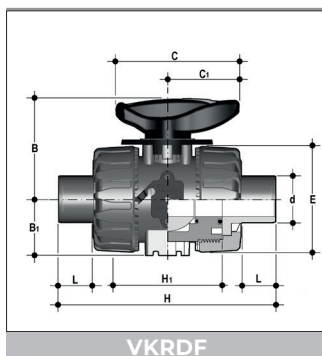

2 WEG KOGELKRANEN VOOR LINEAIRE DEBIETREGELING
VANNES A BILLE A 3 VOIES POUR REGULATION LINEAIRE DU DEBIT
2 WAY BALL VALVES FOR LINEAR FLOW CONTROL

Mannelijke lasmof.

Volledig uitwisselbaar met kogelkransen type VK Dual Block®.

Bereik: 0-90° / monodirectioneel. Met schaalverdeling per 5°.

Op aanvraag: elektrisch met posi 4-20mA / pneumatisch met klepstandsteller 4-20mA.

Bouts mâles à souder.

Complètement interchangeable avec les robinets à bille VK Dual Block®.

Portée: 0-90° / mono directionnel. Graduation visuelle par 5°.

Sur demande: actuateur électrique avec Posi 4-20mA / actuateur pneumatique avec positionneur 4-20mA.

Spigots for socket welding.

Complete interchangeability with VK Dual Block® series.

Range of use: 0-90° / unidirectional flow. Accuracy of the reading position 5°.

On request: electric actuator with Posi card 4-20mA / pneumatic actuator with positioner 4-20mA.

D	DN	PN	L	H	H ¹	E	B	B ¹	C	C ¹	G/ST/PC	€/ST/PC FPM
20	15	16	16	124	65	54	54.0	29.0	67	40	299	322.87
25	20	16	18	144	70	65	65.0	34.5	85	49	466	373.38
32	25	16	20	154	78	73	69.5	39.0	85	49	604	448.52
40	32	16	22	174	88	86	82.5	46.0	108	64	951	541.30
50	40	16	23	194	93	98	89.0	52.0	108	64	1284	896.69
63	50	16	29	224	111	122	108.0	62.0	134	76	2229	1495.99



kranen
vannes
valves

DUAL BLOCK®

PVDF-SOLEF®

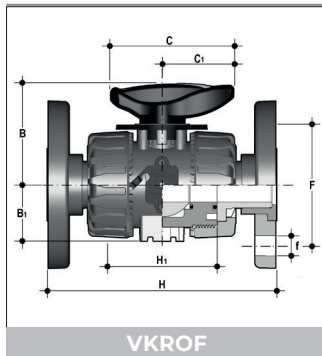

2 WEG KOGELKRANEN VOOR LINEAIRE DEBIETREGELING
VANNES A BILLE A 3 VOIES POUR REGULATION LINEAIRE DU DEBIT
2 WAY BALL VALVES FOR LINEAR FLOW CONTROL

Volledig uitwisselbaar met kogelkransen type VK Dual Block® met DIN 8063, DIN 2501 vaste flenzen. Inbouwlengthe volgens EN 558-1.

Bereik: 0-90° / monodirectioneel. Met schaalverdeling per 5°

Op aanvraag: elektrisch met posi 4-20mA / pneumatisch met klepstandsteller 4-20mA.

Complètement interchangeable avec les robinets à bille VK Dual Block® avec brides fixes DIN 8063, DIN 2501. Encombrement selon EN 558-1.

Portée: 0-90° / mono directionnel. Graduation visuelle par 5°.

Sur demande: actuateur électrique avec Posi 4-20mA / actuateur pneumatique avec positionneur 4-20mA.

Complete interchangeability with VK Dual Block® with DIN 8063, DIN 2501 fixed backing rings. Face to face according EN 558-1.

Range of use: 0-90° / unidirectional flow. Accuracy of the reading position 5°.

On request: electric actuator with Posi card 4-20mA / pneumatic actuator with positioner 4-20mA.

D	DN	PN	B	B1	C	C1	F	H	H1	f	Sp	G/ST/PC	€/ST/PC FPM
20	15	16	54.0	29.0	67	40	65	130	65	14	11	547	473.92
25	20	16	65.0	34.5	85	49	75	150	70	14	14	772	547.56
32	25	16	69.5	39.0	85	49	85	160	78	14	14	1024	681.51
40	32	16	82.5	46.0	108	64	100	180	88	18	14	1583	817.18
50	40	16	89.0	52.0	108	64	110	200	93	18	16	2024	1287.84
63	50	16	108.0	62.0	134	76	125	230	111	18	16	3219	1955.98



VLINDERKLEPPEN -	HANDBEDIEND	FKOF
VANNES PAPILLON -	AVEC POIGNEE	FKOF
BUTTERFLY VALVES -	HAND OPERATED	FKOF

Afmetingen / dimensions / overall dimensions:

ISO 5752 (DN 40-200 medium seri 25, DN 250-3000 long serie 16)
DIN 3202 (DN 65-200 K2, DN 250-300 K3)

Materialen / matériaux / materials:

Lichaam / corps / body: PP-GR
Klepblad / papillon / disc: PVDF
Axe / axe / stem: RVS AISI 420 (AISI 316 op aanvraag / sur demande / on request)
Zitting / siège / liner: EPDM, FPM (NBR op aanvraag / sur demande / on request)

Wafer type:

Tussen flenzen / entre brides / between flanges:
EN ISO 1452, EN ISO 15493, DIN 2501, ISO 7005-1, EN 1092-1, ASTM B16.5 Cl. 150

Opmerking / remarque / remark:

Alvorens vlinderkleppen te monteren, is het aan te raden eerst de binnendiameter van de kragen te controleren. Bij bepaalde diameters kan een aanpassing van de kragen noodzakelijk zijn.

Avant d'effectuer l'installation de vannes papillons, il est conseillé de vérifier le diamètre intérieur des collets. En certains cas, il est nécessaire de chamfreiner.

Before installing butterfly valves, it is advisable to check the internal diameter of the stubs.
For certain dimensions, it is necessary to chamfer the stubs.

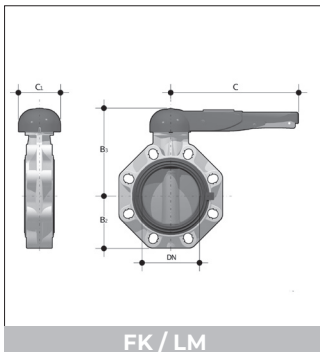

FK / LM

d	DN	PN	B ²	B ³	C	C ¹	Z	G/ ST/PC	U	€/ST/PC FPM
50	40	16	60	137	175	100	33	900	4	472.00
63	50	16	70	143	175	100	43	1080	4	499.79
75	65	10	80	164	175	100	46	1470	4	555.30
90	80	10	93	178	272	110	49	1870	8	578.24
110	100	10	107	192	272	110	56	2220	8	614.34
140	125	10	120	212	330	110	64	3100	8	816.52
160	150	10	134	225	330	110	70	3850	8	839.47
225	200	10	161	272	420	122	71	6750	8	1088.67

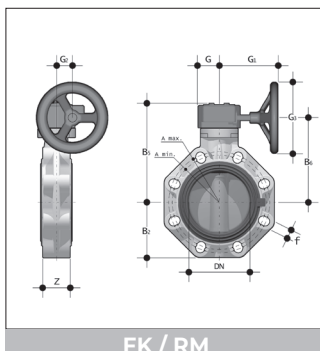

FK / RM

d	DN	PN	B ²	B ⁵	B ⁶	G	G ¹	G ²	G ³	Z	G/ ST/PC	U	€/ST/PC FPM
75	65	10	80	174	146	48	135	39	125	46	2400	4	994.74
90	80	10	93	188	160	48	135	39	125	49	2800	8	1017.69
110	100	10	107	202	174	48	135	39	125	56	3150	8	1054.78
140	125	10	120	222	194	48	144	39	200	64	4450	8	1255.92
160	150	10	134	235	207	48	144	39	200	70	5200	8	1278.86
225	200	10	161	287	256	65	204	60	200	71	9300	8	1628.68
250	250	10	210	317	281	88	236	76	250	114	18600	12	4118.08
280	250	10	210	317	281	88	236	76	250	114	18600	12	4118.08
315	300	8	245	374	338	88	236	76	250	114	25600	12	4462.42
355	350	7	280	438	390	88	361	80	300	129	36845	16	8898.28
400	400	6	306	438	390	88	361	80	300	169	45745	16	10745.19

TYPE LUG:

met draadogen (DIN 5202, ANSI B16.5 cl. 150) op aanvraag
avec oreilles taraudées (DIN 5202, ANSI B16.5 cl. 150) sur demande
with threaded holes (DIN 5202, ANSI B16.5 cl. 150) on request



toeberehen voor kranen VKD - TKD - VKR
 accessoires pour vannes VKD - TKD - VKR
 accessories for valves VKD - TKD - VKR

PVDF-SOLEF®

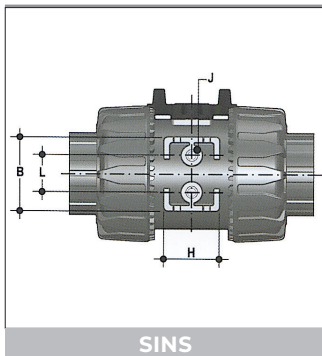

DRAADBUSSEN
 BUSELURES
 THREADED INSERTS

D	DN	B	H	L	J	€/ST/PC = 20 ST/PC	
						Messing Laiton Brass	RVS 316 Inox 316 SS 316
16	10	31.5	27	20	M4 x 6	15.51	85.49
20	15	31.5	27	20	M4 x 6	15.51	85.49
25	20	40.0	30	20	M4 x 6	15.51	85.49
32	25	40.0	30	20	M4 x 6	15.51	85.49
40	32	50.0	35	30	M6 x 10	18.65	94.56
50	40	50.0	35	30	M6 x 10	18.65	94.56
63	50	60.0	40	30	M6 x 10	18.65	94.56

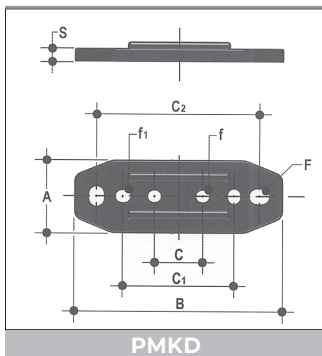

MONTAGEPLAAT
 PLATINE
 MOUNTING PLATE

D	DN	A	B	C	C1	C2	F	f	f1	S	€/ST/PC
16	10	30	86	20	46	67.5	6.5	5.3	5.5	5	8.78
20	15	30	86	20	46	67.5	6.5	5.3	5.5	5	8.78
25	20	30	86	20	46	67.5	6.5	5.3	5.5	5	8.78
32	25	30	86	20	46	67.5	6.5	5.3	5.5	5	8.78
40	32	40	122	30	72	102.0	6.5	6.3	6.5	6	9.57
50	40	40	122	30	72	102.0	6.5	6.3	6.5	6	9.57
63	50	40	122	30	72	102.0	6.5	6.3	6.5	6	9.57

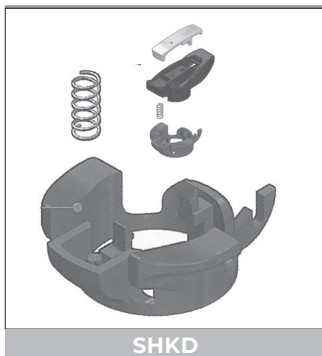

KIT HANDVAT VERGREDELING 0-90°
 KIT DE VERROUILLAGE 0-90°
 HANDLE BLOCK KIT 0-90°

D	€/ST/PC
16 - 20	16.74
25 - 32	18.69
40 - 50	21.61
63	23.19

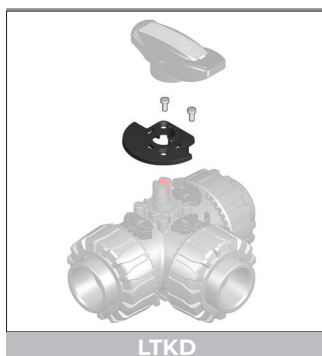

HENDEL STOP 90°/180° KOERSBEPERKER 3 WEG KOGELKRAAN
 BUTÉE DE POIGNÉE 90°/180° LIMITEUR DE COURSE VANNE A BOULE 3 VOIES
 HANDLE STOP 90°/180° STROKE LIMITER 3 WAY BALL VALVE

Voor / pour / for : TKD

D	€/ST/PC	
	LTKD 90°	LTKD 180°
16-20	16.74	16.74
25-32	20.42	20.42
40-50	24.44	24.44
63	30.65	30.65



toebereiden voor kranen VKD - TKD - VKR
 accessoires pour vannes VKD - TKD - VKR
 accessories for valves VKD - TKD - VKR

PVDF-SOLEF®

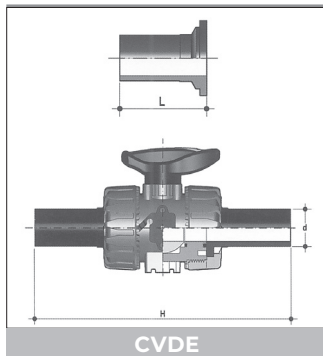

HDPE 100 CONNECTOR VOOR STOMPLAS & ELECTROLAS
 CONNECT. HDPE 100 SOUDAGE BOUT A BOUT OU ELECTROSOUDAGE
 HDPE 100 END CONNECTOR FOR BUTT WELDING OR ELECTROFUSION

Voor / pour / for : VKD / TKD / SXE / RV / VV / VR / VKR / SSE / VEE

d	DN	L	H	€/ST/PC
20	15	55	175	3.33
25	20	70	210	3.40
32	25	74	226	3.42
40	32	78	243	5.34
50	40	84	261	6.34
63	50	91	293	9.02
75	65	110	356	25.31
90	80	118	390	32.91
110	100	130	431	38.24

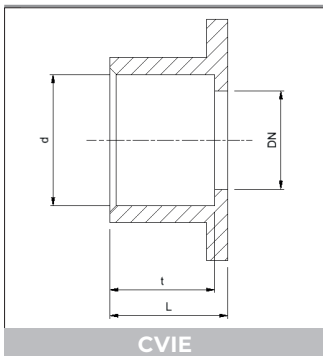

HDPE 100 CONNECTOR VOOR MOFLAS
 CONNECT. HDPE 100 POUR SOUDAGE A L'EMBOITURE
 HDPE 100 END CONNECTOR FOR SOCKET WELDING

Voor / pour / for : VKD / TKD / SXE / RV / VV / VR / VKR / SSE / VEE

d	DN	L	t	€/ST/PC
20	15	18	16.0	9.23
25	20	22	17.0	9.85
32	25	25	19.5	10.37
40	32	28	22.0	10.99
50	40	34	25.0	12.40
63	50	43	29.0	21.15

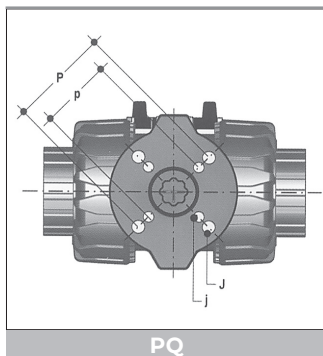

POWERQUICK

Opbouwmodule in PP-GVK geschikt voor VKD + TKD + VKR
 Kit d'accouplement en PP-FRP pour VKD + TKD + VKR
 Module for assembly in PP-FRP for VKD + TKD + VKR

d	DN	B2	T	p x j	P x J
16	10	58.0	16	F03 x 5.5	F04 x 5.5
20	15	58.0	16	F03 x 5.5	F04 x 5.5
25	20	73.5	16	F03 x 5.5	F05 x 6.5
32	25	74.0	16	F03 x 5.5	F05 x 6.5
40	32	97.0	16	F05 x 6.5	F07 x 8.5
50	40	104.0	16	F05 x 6.5	F07 x 8.5
63	50	114.0	16	F05 x 6.5	F07 x 8.5

* F04 x 5.5 op aanvraag / sur demande / on request

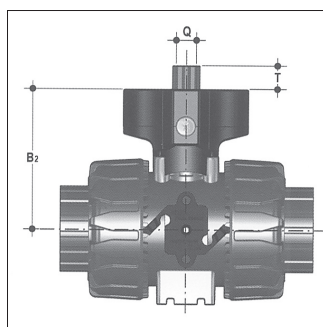

d	Actuators CP (FIP)		Actuators CE (FIP)		Kit €/ST/PC
	ISO	SQUARE	ISO	SQUARE	
16 - 20	F03-04*	11	F03	14	66.20
25	F03-05*	11	F03	14	70.21
25	F04	11	F04	14	70.21
32	F03-05*	11	F03	14	70.21
32	F04	14	F04	14	70.21
40	F05-07*	14	F05	14	80.23
50	F05-07*	14	F05	14	80.23
63	F05-07*	14	F05	14	85.26



toeberehen voor kranen VKD - TKD - VKR
accessoires pour vannes VKD - TKD - VKR
accessories for valves VKD - TKD - VKR

PVDF-SOLEF®



LSQT

MICROSWITCHBOX MET TERUGMELDINGEN
BOITIER FIN DE COURSE
LIMIT SWITCH BOX

Geschikt voor montage op VKD + TKD kogelkranen in combinatie met LSQTKIT montageset.
Pour vannes à boule VKD + TKD montage par l'aide du kit de montage LSQTKIT.
For VKD+TKD ballvalves, to be installed with LSQTKIT mounting kit.

D	DN	A	A1	B	B1	C	C1
16	10	60	91.5	137.0	29.0	76.5	157.5
20	15	60	91.5	137.0	29.0	76.5	157.5
25	20	71	102.5	148.0	34.5	76.5	157.5
32	25	76	107.5	153.0	39.0	76.5	157.5
40	32	93	124.5	170.0	46.0	76.5	157.5
50	40	99	130.5	176.0	52.0	76.5	157.5
63	50	116	147.5	193.0	62.0	76.5	157.5
75	65	-	-	275.0	87.0	103.0	126.9
90	80	-	-	286.7	105.0	103.0	126.9
110	100	-	-	305.5	129.0	103.0	126.9

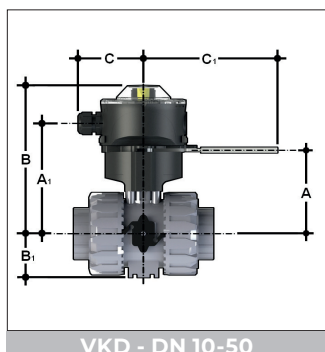

VKD - DN 10-50

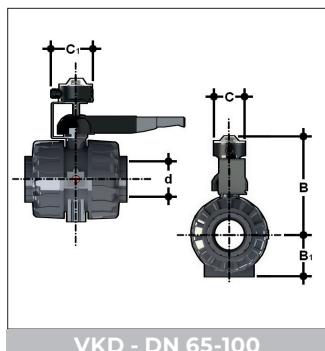

VKD - DN 65-100

d	€/ST/PC Montageset Kit de montage Mounting kit	€/ST/PC Electromechanisch Electromécanique Electro mechanical	€/ST/PC Inductief 3 draads PNP Inductif 3 fils PNP Inductive 3 wire PNP
16 - 20	LSQKIT020 84.89	LSQTMEC 295.25	LSQTPNP 503.25
25	LSQKIT025 90.01	LSQTMEC 295.25	LSQTPNP 503.25
32	LSQKIT032 90.01	LSQTMEC 295.25	LSQTPNP 503.25
40	LSQKIT040 102.91	LSQTMEC 295.25	LSQTPNP 503.25
50	LSQKIT050 102.91	LSQTMEC 295.25	LSQTPNP 503.25
63	LSQKIT063 109.34	LSQTMEC 295.25	LSQTPNP 503.25
75-90-110	LSQKIT75160 203.03	LSQTMEC 295.25	LSQTPNP 503.25

Afsluiter niet incl., vanne non incl., valve not incl.

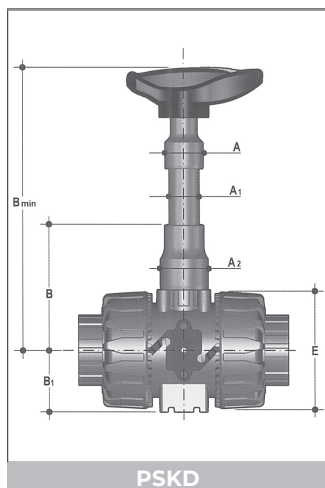

PSKD

VERLENGDE SPINDEL
EXTENSION DE COMMANDE
STEM EXTENSION

D	DN	A	A1	A2	E	B	B1	B min	€/ST/PC*
16	10	32	25	32	54	70.0	29.0	139.5	34.97
20	15	32	25	32	54	70.0	29.0	139.5	34.97
25	20	32	25	40	65	89.0	34.5	164.5	35.72
32	25	32	25	40	73	93.5	39.0	169.0	36.66
40	32	40	32	50	86	110.0	46.0	200.0	37.03
50	40	40	32	50	98	116.0	52.0	206.0	38.55
63	50	40	32	59	122	122.0	62.0	225.0	42.54

D75-90-110 op aanvraag / sur demande / on request

* PVC buis niet inbegrepen, tuyau en PVC pas inclus, PVC pipe not included .



toeberehen voor kranen FK
accessoires pour vannes FK
accessories for valves FK

PVDF-SOLEF®



LSQT

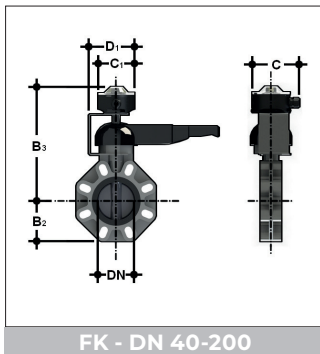

FK - DN 40-200

MICROSWITCHBOX MET TERUGMELDINGEN
BOITIER FIN DE COURSE
LIMIT SWITCH BOX

Geschikt voor montage op FK vlinderkleppen in combinatie met LSQTKIT montageset.
Pour vannes papillon FK montage par l'aide du kit de montage LSQTKIT.
For FK butterfly valves, to be installed with LSQTKIT mounting kit.

D	B2	B3	C	C1	D1
40	60	260.5	126.9	103	123.5
50	70	266.5	126.9	103	123.5
65	80	273.5	126.9	103	123.5
80	93	287.5	126.9	103	123.5
100	107	301.5	126.9	103	123.5
125	120	321.5	126.9	103	123.5
150	134	334.5	126.9	103	123.5
200	161	385.0	126.9	103	129.8

d	€/ST/PC Montageset Kit de montage Mounting kit	€/ST/PC Electromechanisch Electromécanique Electro mechanical	€/ST/PC Inductief 3 draads PNP Inductif 3 fils PNP Inductive 3 wire PNP
50-63	LSKITFK5063 150.78	LSQTMEC 295.25	LSQTPNP 503.25
75-160	LSKITF75160 203.03	LSQTMEC 295.25	LSQTPNP 503.25
225	LSKIT225 216.72	LSQTMEC 295.25	LSQTPNP 503.25

*Afsluiter niet incl., vanne non incl., valve not incl.

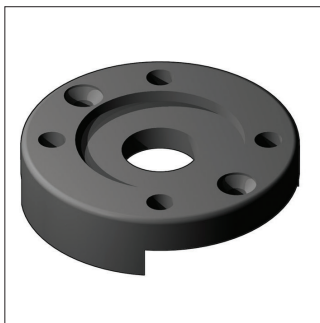

Adaptor voor opbouw aandrijving (elektrisch / pneumatisch) ISO 5211
Adaptateur pour montage actuateur (electrique / pneumatique) ISO 5211
Adaptor for mounting of actuator (electrical / pneumatic) ISO 5211

d 50 160 : 24.45 €/ST/PC
d 225 : 29.76 €/ST/PC



kranen
vannes
valves

PVDF-SOLEF®

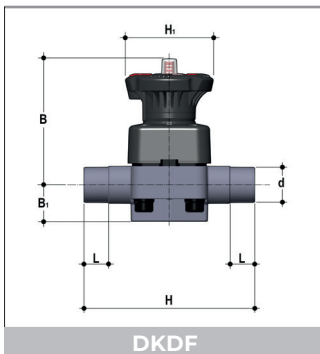

DKDF

MEMBRAANKRANEN
VANNES A MEMBRANE
DIAPHRAGM VALVES

PN 10

Uitwendige lasmoffen.
Bouts mâles à souder.
Exterior welding sleeves.

D	DN	L	H	H ₁	B	B ₁	G/ST/PC	€/ST/PC		
								EPDM	FPM	PTFE
20	15	16	124	80	102	25	497	133.61	182.71	204.07
25	20	19	144	80	105	30	527	138.67	190.27	210.39
32	25	22	154	80	114	33	756	159.99	210.39	229.30
40	32	26	174	80	119	30	817	260.82	343.93	367.94
50	40	31	194	120	147	35	1700	299.91	384.27	408.26
63	50	38	224	120	172	46	2693	379.21	519.08	515.27
75	65	44	284	120	172	46	2871	455.04	622.85	618.29
* 90	80	51	300	215	225	55	7778	1394.87	1807.49	1588.31
*110	100	61	300	250	295	69	11637	1773.75	2462.83	2012.56

* PTFE: PN 6 / TYPE VMDF

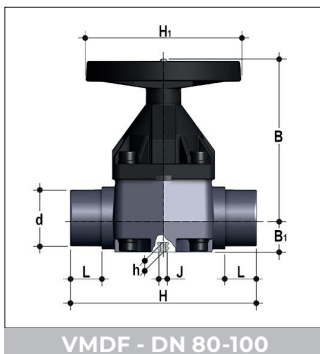

VMDF - DN 80-100

MEMBRAANKRANEN
VANNES A MEMBRANE
DIAPHRAGM VALVES

PN 10

Aansluiting met driedelige koppelingen.
Raccordement à raccords-union 3 pièces.
Connection with socket unions.

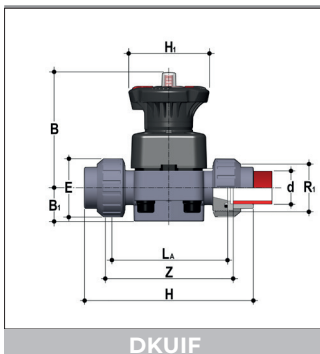

DKUIF

D	d	B	B ₁	E	H	H ₁	L _A	R ₁	Z	G/ST/PC	€/ST/PC		
											EPDM	FPM	PTFE
20	15	102	25	41	128	80	90	1"	101	1054	180.20	229.30	250.74
25	20	105	30	50	150	80	108	1 1/4"	119	1125	190.27	241.94	262.07
32	25	114	33	58	163	80	116	1 1/2"	127	1185	226.79	277.19	296.01
40	32	119	30	72	184	80	134	2"	145	2086	361.57	444.70	468.66
50	40	147	35	79	210	120	154	2 1/4"	165	2173	419.55	502.72	526.64
63	50	172	46	98	248	120	184	2 3/4"	195	3447	543.03	682.81	679.11



kranen
vannes
valves

PVDF-SOLEF®

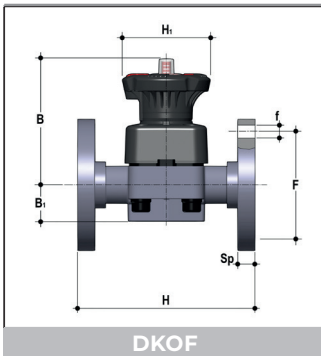

DKOF

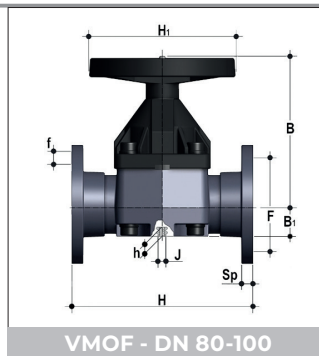

VMOF - DN 80-100

MEMBRAANKRANEN
VANNES A MEMBRANE
DIAPHRAGM VALVES

PN 10

Flensaansluiting, vaste flenzen volgens DIN 2501.
Raccordement à brides fixes, selon DIN 2501.
Flanged connection with fixed backing rings DIN 2501.

d	DN	B	B1	H	H1	F	f	Sp	U	G/ST/PC	€/ST/PC		
											EPDM	FPM	PTFE
20	15	102	25	130	80	65	14	13.5	4	810	241.55	290.67	312.00
25	20	105	30	150	80	75	14	13.5	4	862	251.31	302.92	322.99
32	25	114	33	160	80	85	14	14.0	4	1141	277.89	328.30	347.19
40	32	119	30	180	80	100	18	14.0	4	1532	436.55	519.67	543.65
50	40	147	35	200	120	110	18	16.0	4	2481	482.77	567.21	591.10
63	50	172	46	230	120	125	18	16.0	4	3690	628.95	768.90	765.05
75	65	225	55	290	120	145	18	21.0	4	4263	817.71	999.52	994.53
* 90	80	225	55	310	200	160	18		8	9151	1787.01	2199.67	1980.42
*110	100	295	69	350	250	180	18		8	13997	2238.57	2927.65	2477.38

* PTFE: PN 6 / TYPE VMOF

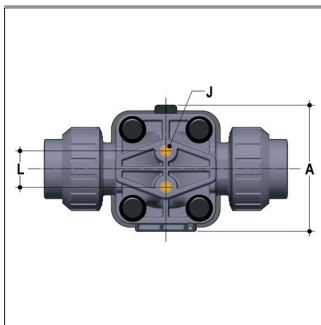

MONTAGEPLAAT
PLATINE
MOUNTING PLATE

D	DN	A	L	J
20	15	74	25.0	M6 x 10
25	20	74	25.0	M6 x 10
32	25	87	25.0	M6 x 10
40	32	87	25.0	M6 x 10
50	40	114	44.5	M8 x 14
63	50	136	44.5	M8 x 14
75	65	136	44.5	M8 x 14

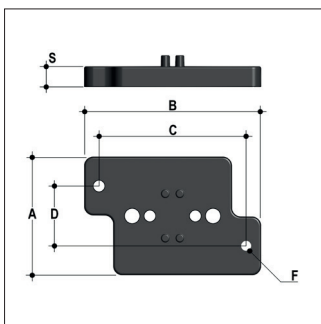

KIT PMDK

KIT PMDK

D	DN	A	B	C	D	F	S	€/ST/PC
20	15	65	97	81	33	5.5	11	17.19
25	20	65	97	81	33	5.5	11	17.19
32	25	65	97	81	33	5.5	11	17.19
40	32	65	97	81	33	5.5	11	19.35
50	40	65	144	130	33	6.5	11	19.35
63	50	65	144	130	33	6.5	11	19.35
75	65	65	144	130	33	6.5	11	19.35

Inclusief 2 RVS schroeven / Inclusif 2 ecroux en inox / 2 stainless steel screws included

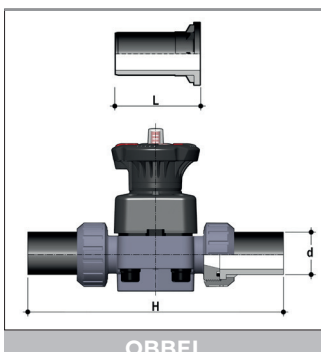

QBBEL

HDPE 100 CONNECTOR VOOR STOMPLAS & ELECTROLAS
CONNECT. HDPE 100 SOUDAGE BOUT A BOUT OU ELECTROSOUDEGE
HDPE 100 END CONNECTOR FOR BUTT WELDING OR ELECTROFUSION

SDR11

d	DN	L	H	€/ST/PC
20	15	95	280	6.10
25	20	95	298	7.14
32	25	95	306	9.06
40	32	95	324	11.59
50	40	95	344	11.97
63	50	95	374	17.44



MEMBRAANAFSLUITERS
ROBINETS A MEMBRANE
DIAPHRAGM COCKS

PN 6

Volgens normen ISO-BS-ASTM.
Selon les normes ISO-BS-ASTM.
According to standards ISO-BS-ASTM.

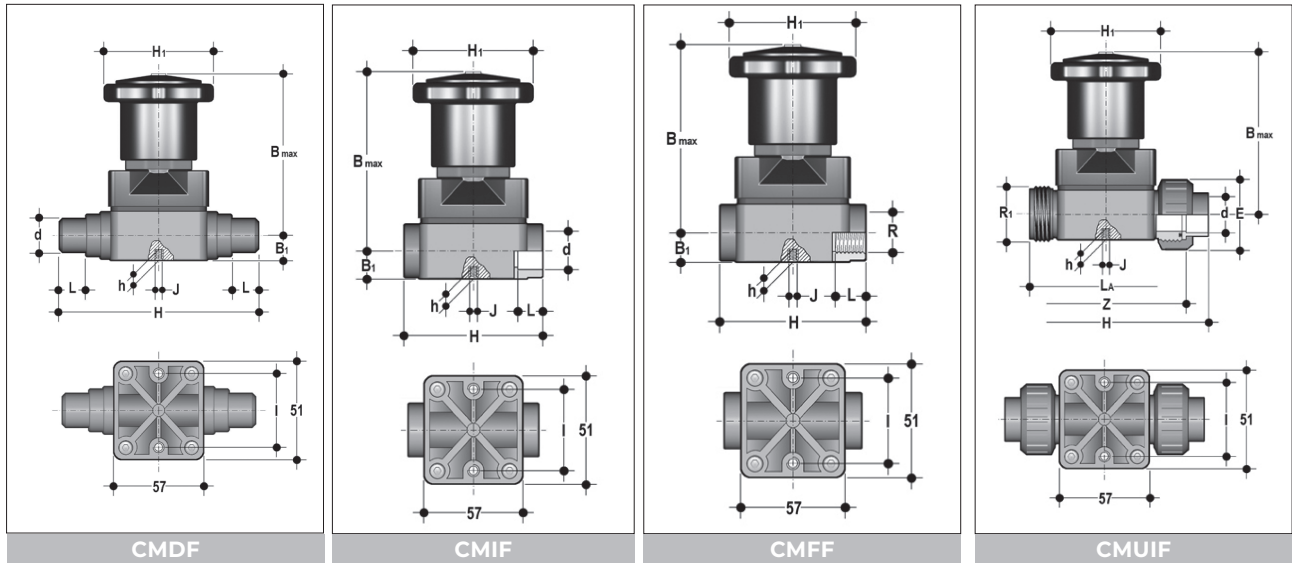

CODE	D/R	DN	B max.	B1	H1	H	h	I	J	L/LA	g	z	R1	E	€/ST/PC		
															EPDM	FPM	CR+PTFE
CMDF	20	15	86	15	58.5	124	8	35	M5	17	270				139.87	150.26	156.67
CMIF	16	12	86	15	58.5	75	8	35	M5	14	240				100.90	108.08	119.64
CMIF	20	15	86	15	58.5	75	8	35	M5	16	240				112.54	132.69	145.45
CMFF	3/8"	12	86	15	58.5	75	8	35	M5	11.5	240				100.90	108.08	119.64
CMFF	1/2"	15	86	15	58.5	75	8	35	M5	15.0	240				112.54	132.69	145.45
CMUIF	20	15	86	-	58.5	130	8	35	M5	90	255	97.5	1"	41	147.15	157.07	163.75



MEMBRAANKRANEN - GROTE DIAMETERS
VANNES A MEMBRANE - GRAND DIAMETRES
DIAPHRAGM VALVES - BIG DIAMETERS

Aansluiting met flenzen. Membraan : PTFE. Prijzen op aanvraag
Raccordement à brides. Membrane : PTFE. Prix sur demande
Flange connection. Diaphragm : PTFE. Prices on request

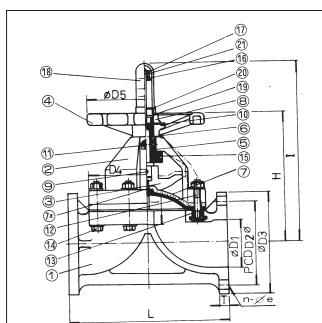

D	DN	PN		L	D	D ²	D ³	H	I	T	e	n	KG/ ST/PC
		EPDM	PTFE										
125/140	125	8	7	400	125	210	250	308	420	23	18	8	23.4
160/180	150	8	5	480	148	240	285	334	476	27	23	8	36.6
200/225	200	3	2	600	196	295	340	419	627	34	23	8	57.0
250/280	250	3	2	730	247	350	385	510	778	36	23	12	107.0

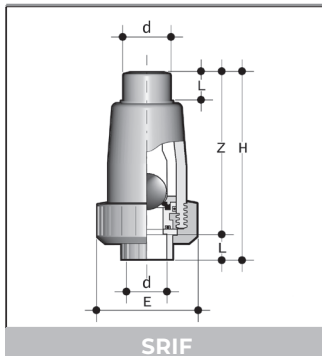

KOGELTERUGSLAGKLEPPEN
CLAPETS DE RETENUE A BILLE
BALL CHECK VALVES

PN 16

Uitwendige mofaansluiting boven en inwendige mofaansluiting onder. Afdichting :FPM-ringen.
In verticale positie gebruiken. Op aanvraag : met flensaansluiting (SROF).

Avec raccords-unions série métrique, à souder par fusion. Etanchéité : joints FPM.
Ne monter les clapets qu'en position verticale. Sur demande : avec raccordement à brides
(SROF).

With metric series end for socket welding. Seals :FPM rings.
Use only in vertical position. On request : with flange connection (SROF).

d	DN	E	L	Z	H	G/ST/PC	€/ST/PC FPM
20	15	54	16	88	104	150	128.59
25	20	65	19	106	125	260	158.07
32	25	74	22	126	148	390	183.93
40	32	86	26	145	171	600	321.57
50	40	98	31	158	189	820	346.53
63	50	119	38	184	222	1420	585.84

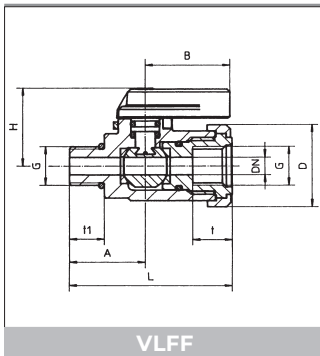

LABO KOGELKRANEN
ROBINETS A BILLE DE LABARATOIRE
LABORATORY BALL VALVES

PN 10

Binnendraad x buitendraad 1/4", inclusief aansluitset met slangpilaar, dubbele nippel en eind-stop.

Dichtingen : FPM, kogelzitting : PTFE.

Filetage intérieur x filetage extérieur, 1/4" inclusif set de branchement avec douille, nippel double et bouchon.

Joints : FPM, anneau d'étanchéité : PTFE.

Female thread x male thread. 1/4" including connection set with hose nozzle, double nipple and plug.

Seals : FPM, ball seat : PTFE.

DN	G	A	B	D	H	L	M	N	t	t ₁	€/ST/PC
6	1/4" BSP	26.0	29	28	26.5	56.0	43.0	16.0	13.5	12.0	57.78
6	3/8" BSP	26.0	29	28	26.5	56.0	43.0	16.0	13.5	12.0	57.78
6	1/4" NPT	28.5	29	28	26.5	58.5	45.5	18.5	13.5	14.5	57.78



kranen
vannes
valves

PVDF-SOLEF®



VR

**TERUGSLAGKLEPPEN MET SCHUINE ZITTING
CLAPTES DE RETENUE A SIEGE INCLINEEU
ANGLE SEAT CHECK VALVES**

PN 16

Met vaste laseinden (VRDF), 3-delige koppelingen met lange IR spiegellaseinden (VRUBF) of opgeschroefde FRP flenzen ISO-DIN (VROF).

Veerbelast (FEP omwikkelde veer), dichtingen EPDM of FPM.

Raccordements par embouts lisses, mâles à souder (VRDF), raccords union à embouts long pour soudage bout à bout IR (VRUBF) ou à brides filetées FRP ISO-DIN (VROF).

Avec ressort (FEP incapsulé), joints d'étanchéité en EPDM ou FPM.

Male spigot ends (VRDF), union ends with long male connectors for IR butt welding (VRUBF) or screwed FRP flanges ISO-DIN (VROF).

Spring loaded (FEP coated), seals in EPDM or FPM.

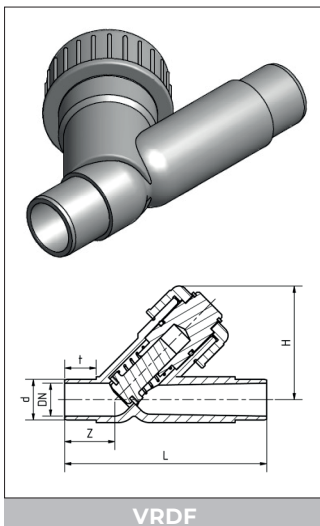

VRDF

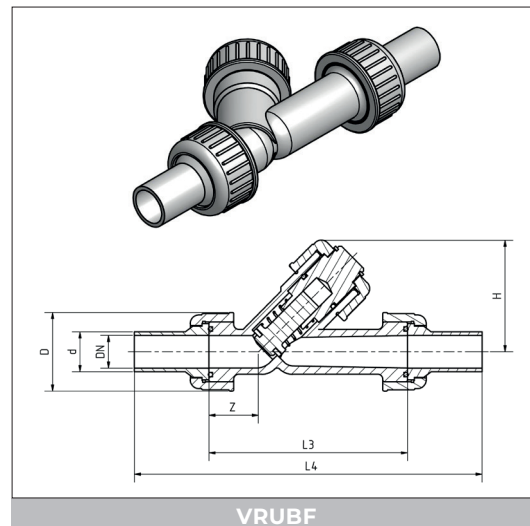

VRUBF

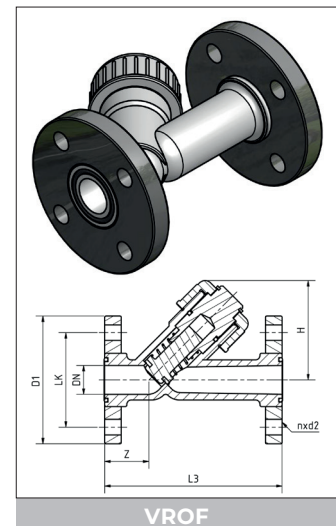

VROF

d	DN	Z	t	H	L	L3	L4	D	LK	D1	n x d2	Kv l/min Δp=1bar
20	15	36	15	75	123	130	238	42	65	95	4 x ø14	95
25	20	36	16	80	143	150	264	48	75	105	4 x ø14	180
32	25	41	18	90	153	160	280	68	85	115	4 x ø14	327
40	32	45	20	110	173	180	306	85	100	140	4 x ø18	484
50	40	51	23	128	195	200	332	85	110	150	4 x ø18	725
63	50	60	27	150	220	230	358	102	125	165	4 x ø18	1130

d	DN	VRDF			VRUBF			VROF		
		G/ST/PC	EPDM €/ST/PC	FPM €/ST/PC	G/ST/PC	EPDM €/ST/PC	FPM €/ST/PC	G/ST/PC	EPDM €/ST/PC	FPM €/ST/PC
20	15	510	338.34	342.65	970	415.34	447.06	980	351.12	382.69
25	20	580	355.59	366.52	1150	446.60	489.87	1210	373.91	417.03
32	25	850	449.37	462.46	1590	546.85	602.00	1800	475.40	530.22
40	32	1390	608.92	628.78	2660	720.41	792.00	2780	633.86	705.63
50	40	2250	927.39	960.35	3420	1061.68	1148.38	3890	938.17	1024.56
63	50	3760	1341.96	1396.78	5520	1500.58	1618.23	5840	1339.95	1458.07



kranen
vannes
valves

PVDF-SOLEF®

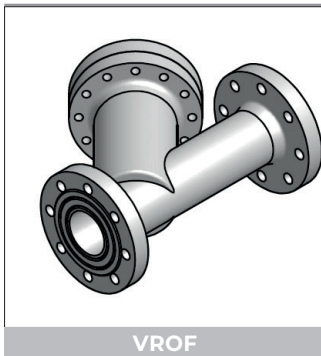

VROF

TERUGSLAGKLEPPEN MET SCHUINE ZITTING GROTE DIAMETERS
CLAPTES DE RETENUE A SIEGE INCLINEEU EN GRAND DIAMETRES
ANGLE SEAT CHECK VALVES BIG DIAMETERS

PN 6

Met vaste flenzen volgens DIN EN 1092-1, DIN2501 PN10.
Veerbelast (FEP omwikkelde veer), dichtingen EPDM of FPM.

A brides fixes suivants DIN EN 1092-1, DIN2501 PN10.
Avec ressort (FEP incapsulé), joints d'étanchéité en EPDM ou FPM.

Fixed flanges acc to DIN EN1092-1, DIN2501 PN10.
Spring loaded (FEP coated), seals in EPDM or FPM.

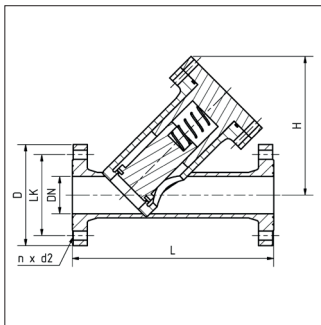

d	DN	H	L	LK	D	n x d2	Kv l/min $\Delta p=1\text{bar}$	G/ST/PC	€/ST/PC EPDM	€/ST/PC FPM
75	65	260	370	145	185	4 x $\phi 18$	500	10000	3864	4294
90	80	275	410	160	200	8 x $\phi 18$	1000	14000	4146	4865
110	100	325	440	180	220	8 x $\phi 18$	1600	17000	8544	9208
160	150	430	600	240	285	8 x $\phi 22$	4500	24000	16757	16911

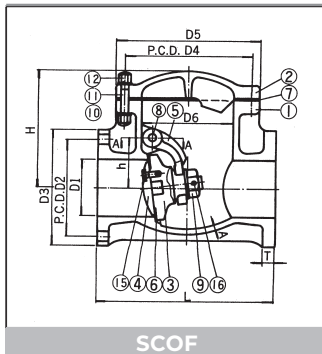

SCOF

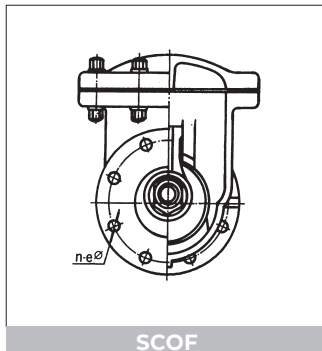

SCOF

SWING TERUGSLAGKLEPPEN
CLAPETS DE RETENUE SWING
SWING CHECK VALVES

Flensaansluiting volgens DIN 2501 PN 10. Dichtingen : PTFE
A brides suivant DIN 2501 PN 10. Joints : PTFE.
With flanges according to DIN 2501 PN 10. Seals : PTFE.

DN	A	B	H	L	T	PN* BAR	G/ST/PC BAR
20	105	86	90	140	15	6	870
25	115	130	120	160	15	6	1780
40	150	145	138	180	16	6	3000
50	165	180	164	200	17	6	4500
65	185	205	171	260	20	6	5700
80	200	205	171	260	20	5	6600
100	220	265	213	300	23	5	11400
125	250	330	238	350	25	4	19600
150	285	370	268	400	30	3	25000
200	340	425	306	500	31	3	40800

* werkdruk bij 20°C

* pression de travail à 20°C

* working pressure at 20°C

Prijzen op aanvraag / prix sur demande / price on request

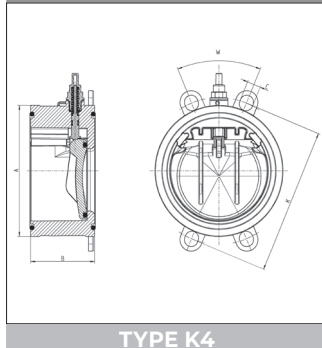

TYPE K4

TERUGSLAGKLEPPEN
CLAPETS DE RETENUE
CHECK VALVES

PN 10

Met standaardwijzer
Opening tot 85°, dichting EPDM of FPM
Verbinding d.m.v. kraag / flens
Leverbaar met veer voor werkdruk van 3 en 6 bar

Avec indicateur de position.
Ouverture jusqu'à 85°, joint EPDM ou FPM
Raccordement avec collet / bride.
Livrable avec ressort pour pression de 3 à 6 bar.

With position indicator
Opening up to 85°, gasket EPDM or FPM
Connection by stub flange / flange
With spring for pressure 3 to 6 bar.

DN	A	B	C	K	W
65	115	63	20	139-145	90°
80	128	71	20	150-160	45°
100	155	80	20	175-191	45° BS
150	212	106	24	234-242	45° BS
200	264	140	24	290-299	45° BS
250	325	140	27	350-362	30° BS

prijzen op aanvraag / prix sur demande / prices on request.

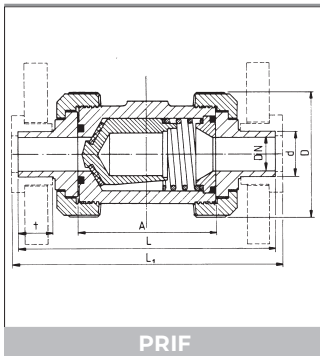

KEGEL TERUGSLAGKLEPPEN MET VEER
CLAPETS DE RETENUE CHARGÉE PAR RESSORT
CHECK BALL VALVES SPRING LOADED

Vrouwelijke lasuiteinden (PRIF), mannelijke lasuiteinden (PRDF), draadaansluiting (PRFF), flensaansluiting (PROF).
Dichtingen: EPDM, FPM, Veer: WSt 1.4401 met PTFE coating.

Bouts femelles à souder (PRIF), bouts mâles à souder (PRDF), filetage femelle (PRFF), à brides (PROF).
Joints: EPDM, FPM Ressort: WSt 1.4401 enrobé avec PTFE.

Welding sockets (PRIF), welding spigots (PRDF), threaded sockets (PRFF), with flanges (PROF).

Seals: EPDM, FPM, spring: WSt 1.4401 with PTFE coating.

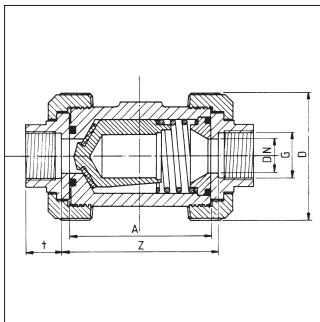
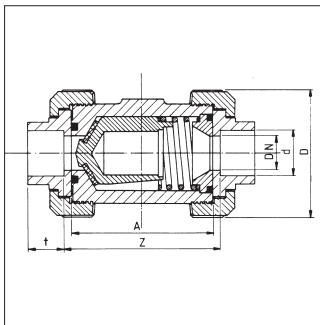

D	DN	G	L	L1	A	Z	t	D	PN
16	10	3/8"	114	120	62	71.0	14.5	52.5	16
20	15	1/2"	124	130	62	67.5	16.0	52.5	16
25	20	3/4"	144	150	69	79.0	17.0	62.0	16
32	25	1"	154	160	73	84.0	19.5	69.5	16
40	32	1 1/4"	174	180	83	96.0	22.0	84.0	16
50	40	1 1/2"	194	200	94	114.0	25.0	100.0	16
63	50	2"	224	230	108	134.0	29.0	120.0	16
75	65	2 1/2"	284	290	133	162.0	34.5	155.0	16
90	80	3"	300	310	160	208.0	38.5	187.0	10
110	80	4"	340	350	160	227.0	44.0	187.0	6

Openingsdruk 0.06 bar.

Pression d'ouverture 0.06 bar.

Opening pressure 0.06 bar.



kranen
vannes
valves

PVDF-SOLEF®



RV

VUILVANGERS
FILTRES A TAMIS
SEDIMENT STRAINERS

PN 16

Met vaste laseinden RVDF), 3-delige koppelingen met lange IR spiegellaseinden (RVUBF) of opgeschroefde FRP flenzen ISO-DIN (RVOF).
Standaard maaswijdte 0,5mm, andere op aanvraag, dichtingen EPDM of FPM.

Raccordements par embouts lisses, mâles à souder (RVDF), raccords union à embouts long pour soudage bout à bout IR (RVUBF) ou à brides filetées FRP ISO-DIN (RVOF).
Trame du filtre 0,5mm, autres sur demande, joints d'étanchéité en EPDM ou FPM.

Male spigot ends (RVDF), union ends with long male connectors for IR butt welding (RVUBF) or screwed FRP flanges ISO-DIN (RVOF).
Standard mesh 0,5mm, others on request, seals in EPDM or FPM.

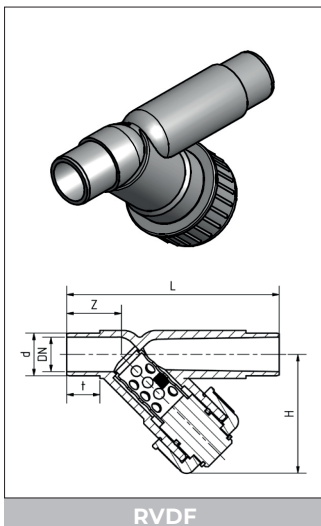

RVDF

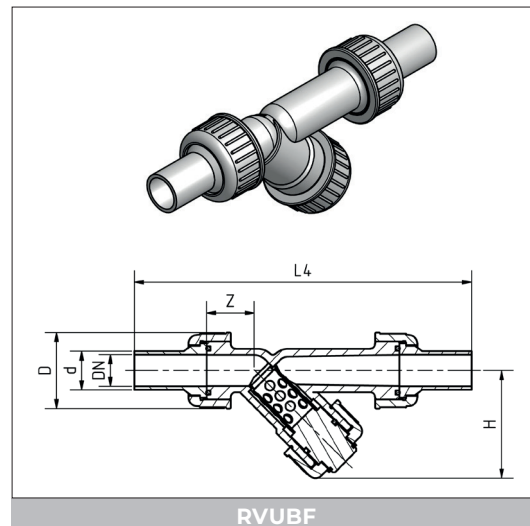

RVUBF

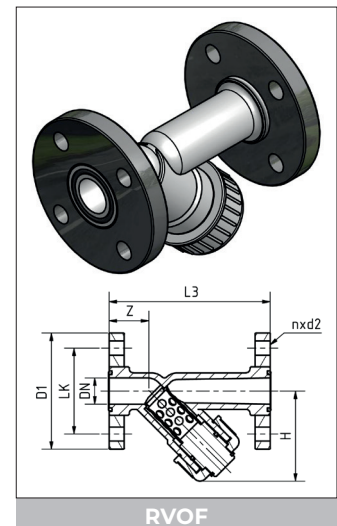

RVOF

d	DN	Z	t	H	L	L3	L4	D	LK	D1	n x d2	Kv l/min Δp=1bar
DIN EN 1092-1 / DIN2501												
20	15	36	15	115	123	130	238	42	65	95	4 x ø14	35
25	20	36	16	115	143	150	264	48	75	105	4 x ø14	65
32	25	41	18	126	153	160	280	68	85	115	4 x ø14	90
40	32	45	20	160	173	180	306	85	100	140	4 x ø18	155
50	40	51	23	174	195	200	332	85	110	150	4 x ø18	225
63	50	60	27	209	220	230	358	102	125	165	4 x ø18	370

d	DN	RVDF			RVUBF			RVOF		
		G/ST/PC	EPDM €/ST/PC	FPM €/ST/PC	G/ST/PC	EPDM €/ST/PC	FPM €/ST/PC	G/ST/PC	EPDM €/ST/PC	FPM €/ST/PC
20	15	500	347.12	351.43	950	423.35	455.22	1000	358.98	390.70
25	20	600	368.83	377.61	1130	454.30	497.42	1250	383.92	427.20
32	25	800	469.40	475.86	1510	559.33	614.15	1690	487.72	542.70
40	32	1300	615.23	624.01	2560	716.25	787.71	2850	629.55	701.32
50	40	2200	947.25	956.03	3300	1057.83	1144.37	3830	934.17	1020.56
63	50	3500	1376.76	1389.85	5220	1495.20	1612.69	5620	1333.95	1451.76

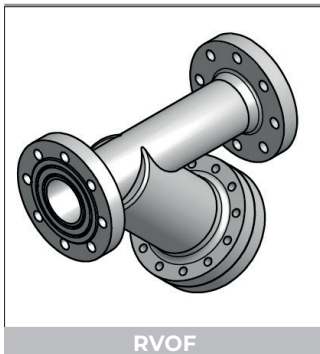

RVOF

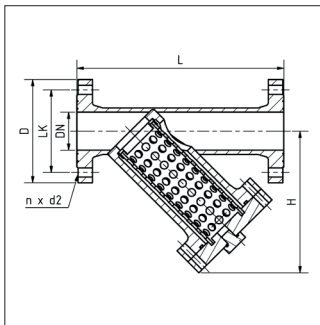

VUILVANGERS IN GROTE DIAMETERS
 FILTRES A TAMIS EN GRAND DIAMETRES
 SEDIMENT STRAINERS IN BIG DIAMETERS

PN 6

Met vaste flenzen volgens DIN EN 1092-1, DIN2501 PN10.
 ETFE filter, standaard maaswijdte 2,0mm, andere op aanvraag, dichtingen EPDM of FPM.

A brides fixes suivants DIN EN 1092-1, DIN2501 PN10.
 Trame du filtre ETFE 2,0mm, autres sur demande, joints d'étanchéité en EPDM ou FPM.

Fixed flanges acc to DIN EN1092-1, DIN2501 PN10.
 ETFE filter, standard mesh 2,0mm, others on request, seals in EPDM or FPM.

d	DN	H	L	LK	D	n x d2	Kv l/min $\Delta p=1\text{bar}$	G/ST/PC	€/ST/PC EPDM	€/ST/PC FPM
75	65	260	370	145	185	4 x $\varnothing 18$	500	10000	3684	3775
90	80	275	410	160	200	8 x $\varnothing 18$	1000	13000	4146	4229
110	100	325	490	180	220	8 x $\varnothing 18$	1600	16000	8544	8640
140	125	380	550	210	250	8 x $\varnothing 22$	3000	25000	16757	16911
160	150	430	600	295	285	8 x $\varnothing 22$	4500	-	-	-
225	200	550	700	350	340	8 x $\varnothing 22$	10000	-	-	-

Op aanvraag :

- Diam. tot DN200
- Versterkte versie met glasvezel versterking
- Manometeraansluiting op de filteruitgang /
- Aftapkraan
- Snelsluitsysteem

Sur demande :

- Diam. jusqu'à DN200
- Version avec renforcement en fibres de verre
- Perçage pour manomètre
- Vanne de purge
- Tendeurs rapides

On request :

- Diam. up to DN200
- Fiberglass reinforced version
- Pressure gauge port
- Drainvalve
- Quick release clamps

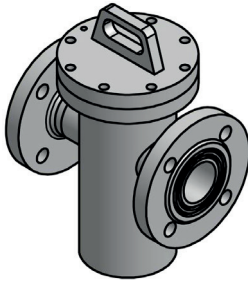

BSOF

MANDFILTERS
FILTRES A PANIER
POT STRAINERS

Met vaste flenzen volgens DIN EN 1092-1, DIN2501 PN10.
ETFE filter, standaard maaswijdte 2,0 mm, andere op aanvraag, dichtingen EPDM of FPM.
Schoonmaken/vervangen filter van bovenuit.

A brides fixes suivants DIN EN 1092-1, DIN2501 PN10.
Trame du filtre ETFE 2,0mm, autres sur demande, joints d'étanchéité en EPDM ou FPM.
Nettoyage /remplacement du filtre par au-dessus.

Fixed flanges acc to DIN EN1092-1, DIN2501 PN10.
ETFE filter, standard mesh 2,0mm, others on request, seals in EPDM or FPM.
Filter cleaning/exchange from above.

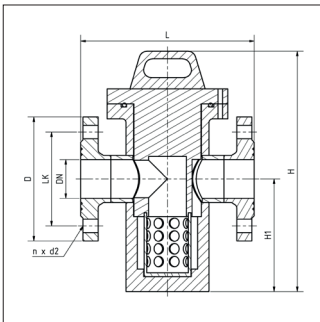

d	DN	PN	H	H1	L	LK	D	n x d2	Kv l/min $\Delta p=1\text{bar}$	G/ST/PC	€/ST/PC EPDM	€/ST/PC FPM
63	50	6	320	150	230	125	165	4 x $\varnothing 18$	350	7000	3367	3464
75	65	6	450	250	255	145	185	4 x $\varnothing 18$	500	10000	3499	3585
90	80	6	480	270	270	160	200	8 x $\varnothing 18$	1000	13000	3940	4018
110	100	6	573	285	350	180	220	8 x $\varnothing 18$	1600	16000	8116	8207
140	125	6	620	365	400	210	250	8 x $\varnothing 22$	3000	25000	15919	16067
160	150		690	410	450	295	285	8 x $\varnothing 22$	4500	-	-	-
225	200		875	555	520	350	340	8 x $\varnothing 22$	10000	-	-	-

Op aanvraag :

- Diameters tot DN200
- Versterkte versie met glasvezel versterking
- Manometeraansluiting op de filteruitgang
- Aftapkraan
- Snelsluitsysteem

Sur demande:

- Diamètres jusqu'à DN200
- Version avec renforcement en fibres de verre
- Perçage pour manomètre
- Vanne de purge
- Tendeurs rapides

On request:

- Sizes up to DN200
- Fiberglass reinforced version
- Pressure gauge port
- Drainvalve
- Quick release clamps



KIJKGLAZEN
REGARDS DE COULEE
INSPECTION GLASSES

Met vaste flenzen volgens DIN EN 1092-1, DIN2501 PN10.
Dubbele afdichting ten behoeve van verhoogde veiligheid (EPDM of FPM).
Borosilikaat kijkglas.

A brides fixes suivants DIN EN 1092-1, DIN2501 PN10.
Double étanchéité pour une sécurité élevée (EPDM ou FPM).
Tube en verre borosilicaté.

Fixed flanges acc to DIN EN1092-1, DIN2501 PN10.
Double process safety through 2 seals (EPDM or FPM).
Tube in borosilicate glass.

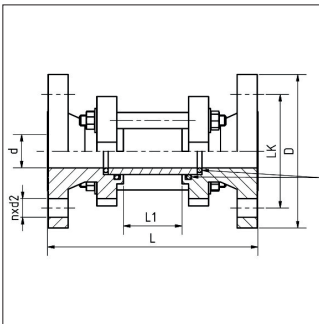

d	DN	PN	L	L1	LK	D	n x d2	G/ST/PC	€/ST/PC	€/ST/PC
DIN EN 1092-1 / DIN2501									EPDM	FPM
20	15	10	140	26	65	95	4 x ø14	1000	665.28	703.78
25	20	10	150	36	75	105	4 x ø14	1600	688.38	733.04
32	25	10	160	46	85	115	4 x ø14	1500	723.80	771.54
40	32	10	180	58	100	140	4 x ø18	1800	782.32	828.52
50	40	10	200	70	110	150	4 x ø18	2400	964.04	1022.56
63	50	10	230	92	125	165	4 x ø18	2900	1304.84	1370.60
75	65	7	290	116	145	185	4 x ø18	4500	1860.32	1928.08
90	80	7	310	126	160	200	8 x ø18	6300	2018.94	2099.02
110	90	6	350	160	180	220	8 x ø18	7000	2597.98	2722.72
140	125	5	400	196	210	250	8 x ø18	16600	3258.64	3384.92
160	150	5	480	244	240	285	8 x ø22	16000	4761.68	4900.28



VLINDERTERUGSLAGKLEPPEN
CLAPETS DE RETENUE PAPILLON UNVM - TYPE 34
BUTTERFLY VALVES - UNVM

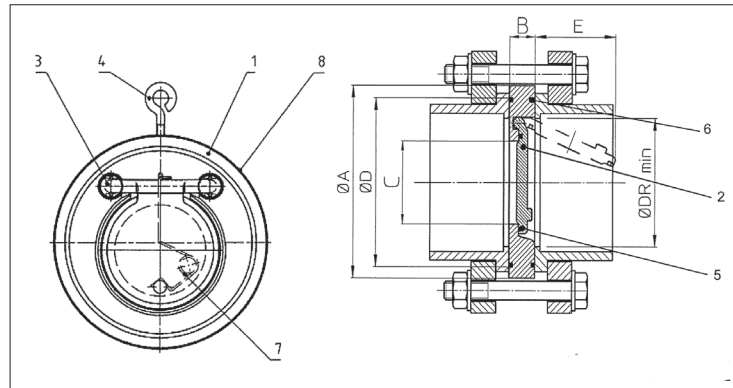

1. body
2. disc
3. screw
4. ring screw
5. O-ring
6. O-ring
7. spring
8. typ plate
9. spacer

Eveneens leverbaar voor ASA 150 flenzen.
Deze terugslagklep is niet geschikt voor pulserende stromingen.
Dichtingen : FPM of PTFE.
Veer : RVS 316 of Hastelloy

Egalement disponibles pour brides ASA 150.
Ces vannes de retenue ne conviennent pas pour des flux pulsés.
Joints : NBR, EPDM, FPM ou PTFE.
Ressort : Inox 316 ou Hastelloy

Also available to fir ASA 150 backing flanges.
These valves are not suitable for pulsating flows.
Seals : NBR, EPDM, FPM or PTFE.
Spring : AISI 316 or Hastelloy

DN	A	B	C	D	E	F	DR	PN
40	95	16	22	72	25	28	43	8
50	109	18	32	86	37	29	54	8
65	129	20	40	105	50	31	70	8
80	144	20	54	119	61	32	82	8
100	164	23	70	146	77	31	106	8
125	195	23	92	173	94	35	131	8
150	220	26	105	197	100	40	159	8
200	275	34	154	255	152	38	207	8
250	330	40	192	312	180	41	260	8
300	380	45	227	363	215	41	309	5

prijzen op aanvraag / prix sur demande / prices on request.



kranen
vannes
valves

PVDF-KYNAR®



27 / DN 15-50
27A / DN 65-100

MONOBLOK KOGELKRANEN
ROBINET A TOURNANT SPHERIQUE - MONOBLOC
MONOBLOC - BALL VALVES

Kogelkranen voor chemische toepassingen. Uniek monoblok design zorgt voor verhoogde zekerheid tegen lekkage. Kogelzittingen en spindelpakking in PTFE. Geflensde uitvoering, manuele bediening met vergrendelbare kunststof hendel.

Robinets à tournant sphérique pour des applications chimiques. En monobloc unique offre une sécurité accrue contre les fuites. Sièges de boule et le joint de tige en PTFE. Exécution à bride, commande manuelle à levier cadenassable en matière synthétique.

Ball valves for chemical applications. Unique monobloc design provides increased security against leakage. Ball seats and spindle gasket in PTFE. Flanged execution, manual control with lockable lever in plastic.

Opties / Option :

- Pneumatische en elektrische aandrijvingen (+ toebehoren)
- spindelverlengingen voor isolatie
- ATEX uitvoering
- dodemanshendel
- terugmeldingen (open-dicht)

- Actionneurs pneumatiques et électriques (+ accessoires)
- rehausse pour calorifugeage
- exécution ATEX
- levier homme mort
- contacts fin de course (ouvert-fermé)

- Pneumatic and electric actuators
- spindle extensions for insulation
- ATEX execution
- spring return handle
- limit switches (open-close)

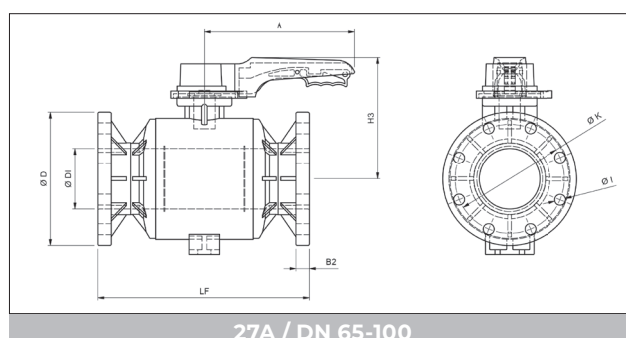
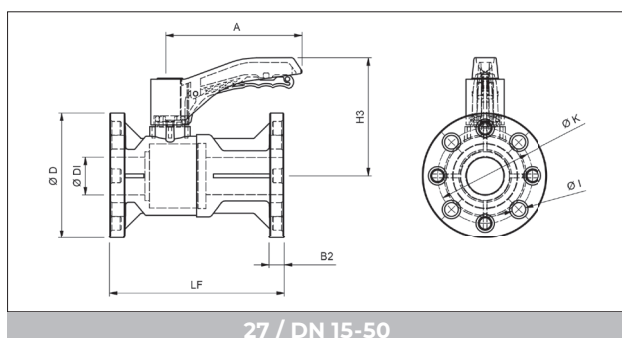

DN	d	G	PN	Kv	Torque	D	H3	A	LF	B2	n x l	K	Bouten Boulon Bolts	Torque*	PVDF	
															m ³ /h	Nm
15	20	1/2"	10	11,1	6	95	115	140	130	13.0	4 x 14	65	4xM12	7,5	212.18	279.05
20	25	3/4"	10	21.0	6	105	115	140	150	14.0	4 x 14	75	4xM12	9.0	227.81	185.70
25	32	1"	10	42.0	8	117	125	140	160	15.0	4 x 14	85	4xM12	10.0	290.98	324.91
32	40	1 1/4"	10	60.0	12	140	145	175	180	17.0	4 x 18	100	4xM16	20.0	365.90	446.71
40	50	1 1/2"	10	96.0	12	150	145	175	200	17,5	4 x 18	110	4xM16	20.0	482.16	508.54
50	63	2"	10	186.0	19	165	155	175	230	18.0	4 x 18	125	4xM16	25.0	587.50	719.63
65	75	2 1/2"	10	300.0	18	185	205	250	290	20.0	4 x 18	145	4xM16	25.0	932.57	1153.15
80	90	3"	10	420.0	18	200	205	250	310	20.0	8 x 18	160	8xM16	30.0	1327.87	1641.02
100	110	4"	10	840.0	40	225	215	250	350	21.0	8 x 18	180	8xM16	30.0	1517.04	1829.58

Torque = draaimoment / couple de manoeuvre / torque operation

Torque* = aandraaimoment flensbouten / couple de serrage boulons / tightening torque flange bolts