

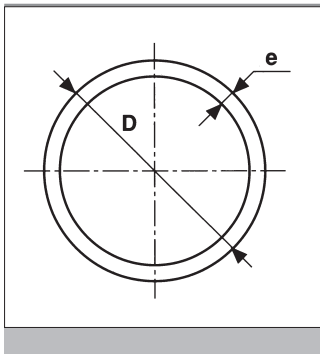

buizen
tuyaux
pipes

VINKAIR



VINKAIR BUIZEN
TUYAUX VINKAIR
VINKAIR PIPES

LICHTBLAUW NF A 571
BLEU CLAIR NF A 571
LIGHT BLUE NF A 571

L = 4m

gladde uiteinden
bouts lisse
butt ends

	Dxs	DN	PN	KG/M	€/M
16 x 1,8		10	12.5	0.106	5.28
20 x 2,3		15	12.5	0.168	6.68
25 x 2,8		20	12.5	0.257	9.49
32 x 2,9		25	12.5	0.340	14.35
40 x 3,7		32	12.5	0.542	27.40
50 x 4,6		40	12.5	0,842	32.27
63 x 5,8		50	12.5	1.334	42.18
75 x 6,8		65	12.5	2.090	62.55
90 x 8,2		80	12.5	3.030	88.35
110 x 10,0		100	12.5	4.480	125.47

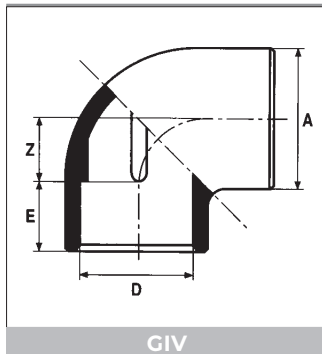

GIV

KNIEEN 90°
 COUDES A 90°
 ELBOWS 90°

PN 12.5

Beide zijden lijmmof / Deux côtés femelles à coller / Sockets for solvent welding

D	DN	Z	E	A	€/ST/PC
16	10	10.0	9.0	21.0	2.47
20	15	11.0	17.0	26.0	2.68
25	20	14.0	19.9	35.8	3.57
32	25	17.0	23.0	44.0	3.90
40	32	23.0	27.0	49.0	9.08
50	40	27.0	31.5	58.0	11.62
63	50	33.0	38.0	73.0	18.08
75	65	39.0	44.0	92.5	38.40
90	80	49.0	52.5	112.0	52.60
110	100	58.0	62.0	131.5	79.19

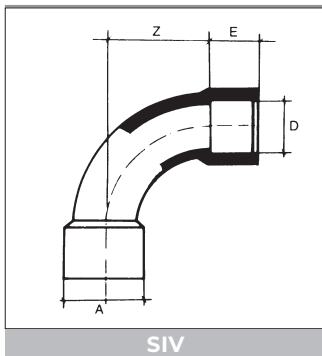

SIV

BOCHTEN 90°
 COURBES A 90°
 BENDS 90°

PN 12.5

Beide zijden lijmmof / Deux côtés femelles à coller / Sockets for solvent welding

D	DN	Z	E	A	R	€/ST/PC
50	40	99	31	64	-	32.60
63	50	127	38	80	-	38.71
75	65	240	62	86	225	99.84
90	80	288	72	103	270	146.72
110	100	352	88	126	330	223.41

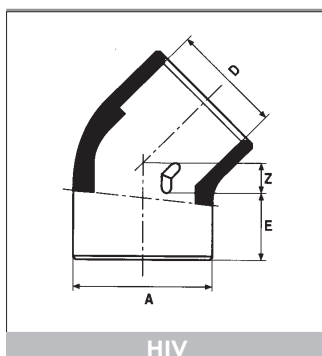

HIV

KNIEEN 45°
 COUDES A 45°
 ELBOWS 45°

PN 12.5

Beide zijden lijmmof / Deux côtés femelles à coller / Sockets for solvent welding

D	DN	Z	E	A	€/ST/PC
16	10	4.5	14.5	21.0	1.51
20	15	4.5	17.0	25.5	1.61
25	20	5.5	19.5	31.5	2.23
32	25	8.0	23.0	39.5	3.43
40	32	9.5	27.0	49.0	5.32
50	40	11.5	32.0	58.0	6.95
63	50	14.0	38.0	72.5	10.61
75	65	18.0	44.0	92.0	21.20
90	80	22.0	52.0	109.0	29.39
110	100	24.0	62.0	131.5	44.05



lijmfittings
raccords à coller
fittings for solvent welding

VINKAIR

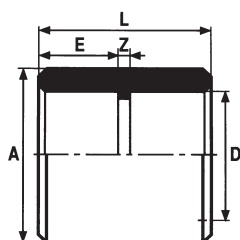

MIV

SOKKEN
MANCHONS
SOCKETS

PN 12.5

Beide zijden lijmmof
Deux côtés femelles à coller
Sockets for solvent welding

D	DN	Z	E	A	L	€/ST/PC
16	10	3.0	15.0	33.0	22.0	2.37
20	15	3.0	17.0	26.0	37.0	2.59
25	20	2.5	20.0	31.5	42.5	3.04
32	25	3.5	23.0	38.0	49.5	4.00
40	32	4.0	26.5	48.0	57.0	6.01
50	40	3.0	32.0	59.5	67.0	9.53
63	50	4.0	38.0	75.5	80.0	12.43
75	65	4.0	45.0	91.0	94.0	28.91
90	80	5.0	52.0	106.5	109.0	51.98
110	100	6.0	62.0	126.5	130.0	75.76

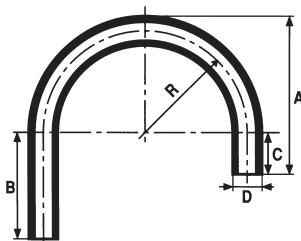

ZIV

U-BOCHTEN 180°
COURBES U A 180°
U BENDS 180°

PN 12.5

Beide zijden lijmmuiteinden.
Deux côtés mâles à coller.
Sockets for spigot welding.

D	DN	R	A	B	C	€/ST/PC
16	10	64	89.0	90	17	24.19
20	15	70	100.0	90	20	24.91
25	20	75	110.5	90	23	25.13
32	25	95	138.0	140	27	34.45



lijmfittings
raccords à coller
fittings for solvent welding

VINKAIR

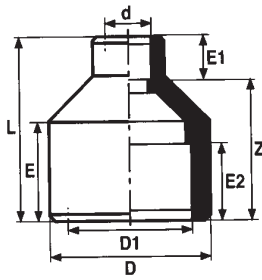

RIV

VERLOOPSTUKKEN
REDUCTIONS
REDUCERS

PN 12.5

Met in- en uitwendige lijmaansluiting
A coller sur l'extérieur et à l'intérieur
Spigot and socket for solvent welding

D-d	DN	D1	Z	E	E1	E2	L	€/ST/PC
25-16	20-10	16.5	25.5	19.0	14.5	14.0	40.0	3.81
32-20	25-15	25.0	31.0	22.5	17.0	19.5	48.0	4.79
40-25	32-20	32.0	36.5	27.0	19.5	21.5	56.0	6.56
50-32	40-25	40.0	45.0	32.0	23.0	27.5	68.0	7.47
63-32	50-25	50.0	55.5	38.5	23.0	32.0	78.5	12.22
63-40	50-32	50.0	55.5	38.5	27.0	32.0	82.5	12.22
75-32	65-25	61.0	62.0	45.0	22.5	38.0	85.0	35.55
90-50	80-40	75.0	74.5	53.0	32.0	44.0	106.5	51.67
90-63	80-50	75.0	75.0	53.0	38.5	44.5	113.5	51.67
110-50	100-40	90.0	90.5	62.0	32.0	52.5	122.5	77.15
110-63	100-50	90.0	92.0	63.5	38.0	54.0	130.0	77.15

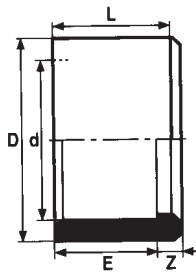

DIV

VERMINDERINGSRINGEN
DOUILLES DE REDUCTIONS
REDUCING BUSHES

PN 12.5

Met in- en uitwendige lijmaansluiting
A coller sur l'extérieur et à l'intérieur
Spigot and socket for solvent welding

D-d	DN	Z	E	L	€/ST/PC
20-16	15	2.5	15.0	17.5	2.11
25-20	20	3.5	17.0	20.5	2.11
32-25	25	5.0	19.5	24.5	3.04
40-32	32	6.0	23.0	29.0	3.93
50-40	40	5.0	27.0	32.0	5.17
63-50	50	7.0	31.5	38.5	7.28
75-63	65	7.5	37.0	44.5	16.79
90-75	80	8.0	44.0	52.0	35.33
110-90	100	10.5	52.0	62.5	56.17

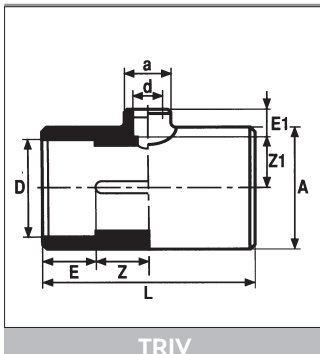
 VERLOOP T-STUKKEN 90°
 TES REDUITS A 90°
 REDUCED TEES 90°

PN 12.5

 Alle zijden lijmmof
 Trois côtés femelles à coller
 Sockets for solvent welding

D-d	DN	Z	Z1	E	E1	L	A	a	€/ST/PC
20-16	15-10	11.0	11.0	17.0	15.0	56.0	26.0	21.0	4.96
25-16	20-10	14.0	14.0	18.5	14.0	66.0	31.0	21.0	6.13
25-20	20-15	13.5	13.0	19.5	16.0	66.0	31.0	26.0	6.13
32-16	25-10	17.0	18.0	23.0	14.0	82.5	44.5	24.0	11.33
32-20	25-15	17.5	18.5	23.5	16.5	82.0	39.0	26.5	11.33
32-25	25-20	18.0	20.0	23.0	19.0	82.0	39.0	31.5	11.33
40-20	32-15	22.0	23.0	27.0	17.0	97.5	49.5	26.5	14.59
40-25	32-20	22.0	23.0	27.0	19.5	97.5	49.5	31.5	14.59
40-32	32-25	22.0	22.0	27.0	23.0	97.5	49.5	39.5	16.17
50-25	40-20	26.5	28.0	31.0	20.0	114.5	60.5	33.0	17.13
50-32	40-25	26.5	28.0	31.0	23.0	115.0	61.0	41.0	17.13
50-40	40-32	26.5	27.0	31.0	26.0	115.0	61.0	50.0	17.13
63-25	50-20	33.5	35.0	38.5	20.0	144.0	80.0	37.0	24.67
63-32	50-25	33.5	35.0	38.5	23.5	144.0	80.0	45.0	24.67
63-40	50-32	33.5	36.0	38.5	27.5	144.0	80.0	54.5	24.67
75-25	65-20	39.0	40.0	44.5	19.5	167.0	92.5	37.0	42.80
75-32	65-25	38.5	38.5	44.5	23.0	166.5	92.5	45.0	42.80
90-25	80-20	46.0	46.5	52.5	19.5	197.0	114.5	37.5	87.45

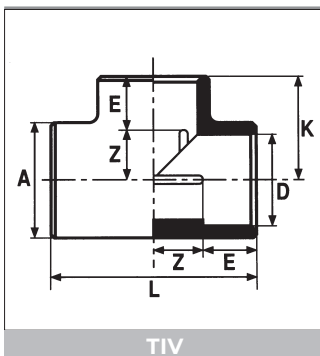
 T-STUKKEN 90°
 TES A 90°
 TEES 90°

PN 12.5

 Alle zijden lijmmof
 Trois côtés femelles à coller
 Sockets for solvent welding

D	DN	Z	E	A	L	K	€/ST/PC
16	10	9.0	14.0	21.0	48.0	24.0	3.71
20	15	11.0	17.0	26.0	56.0	28.0	3.62
25	20	14.0	19.0	31.5	66.5	34.0	5.32
32	25	17.0	22.9	45.0	81.0	40.1	7.64
40	32	22.0	27.0	49.5	97.5	50.0	12.02
50	40	26.5	31.0	61.0	115.0	58.0	17.03
63	50	32.5	38.5	78.0	142.0	72.0	26.83
75	65	39.0	44.5	91.5	166.5	83.0	57.39
90	80	45.0	53.0	112.0	196.5	98.0	81.08
110	100	55.5	62.5	132.0	236.0	119.0	156.61

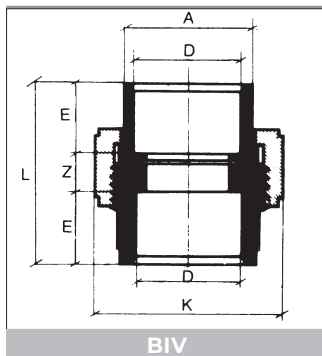

BIV

 DRIEDELIGE KOPPELINGEN
 RACCORDS UNION 3 PIECES
 SOCKET UNIONS 3 PIECES

PN 12.5

 Alle zijden lijmof, dichting EPDM
 Trois côtés femelles à coller, joint EPDM
 Sockets for solvent welding, seal EPDM

D	DN	Z	E	A	K	L	€/ST/PC
16	10	14.0	15.0	22.0	34.5	44.0	13.20
20	15	14.0	16.5	27.5	42.5	47.0	13.20
25	20	13.5	19.0	36.0	54.5	51.5	13.20
32	25	14.5	22.5	41.5	62.5	59.5	14.97
40	32	15.0	27.0	53.0	75.5	69.0	21.61
50	40	19.0	31.5	59.0	83.0	82.0	25.30
63	50	22.0	38.5	74.0	100.5	99.0	33.66

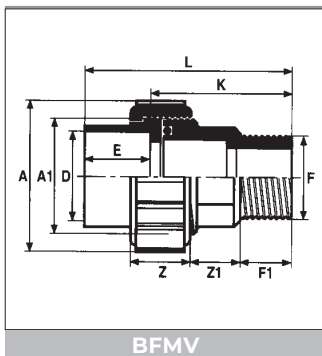

BFMV

 DRIEDELIGE KOPPELINGEN
 RACCORDS UNION 3 PIECES
 SOCKET UNIONS 3 PIECES

PN 12.5

 Eén zijde lijmof, één zijde buitendraad, dichting EPDM
 Un côté femelle à coller, autre côté filetage male, joint EPDM
 One end socket for solvent welding, other end male tread, seal EPDM

D x G	DN	Z	Z1	F1	L	A	A1	K	E	€/ST/PC
16 x 3/8"	10	19.0	11.5	11.5	52.0	36.0	3/4"	36.5	15.5	15.09
20 x 1/2"	15	23.0	11.0	16.5	61.0	42.0	1"	40.0	17.0	16.65
25 x 3/4"	20	25.0	17.0	18.0	72.0	55.0	1 1/4"	49.0	19.0	18.13
32 x 1"	25	26.0	17.5	20.5	80.5	62.5	1 1/2"	53.5	23.0	23.60
40 x 1 1/4"	32	30.5	17.0	23.0	88.0	73.0	2"	57.5	27.0	36.17
50 x 1 1/2"	40	34.0	21.0	27.0	109.0	81.5	2 1/4"	62.0	32.0	36.55
63 x 2"	50	38.0	22.0	31.5	125.0	99.0	2 3/4"	68.0	38.0	43.81

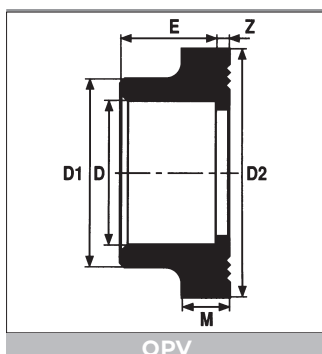

QPV

 GEGROEFDE KRAAGBUSSEN
 COLLETS STRIES
 GROOVED COLLARS

PN 12.5

 Met lijmof, geleverd zonder dichtingsring
 Un côté femelle à coller, livré sans joint
 Socket for solvent welding, delivered without seal

D	DN	Z	E	D2	M	D1	€/ST/PC
50	40	3	32.0	73	8	61	14.42
63	50	3	38.5	90	9	76	20.36
75	65	3	44.0	106	10	90	35.16
90	80	5	52.0	125	11	108	49.85
110	100	5	62.0	150	12	130	69.51



lijmfittings
raccords à coller
fittings for solvent welding

VINKAIR

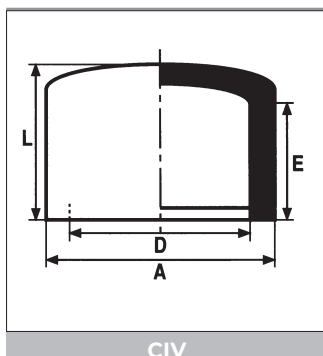

CIV

EINDKAPPEN
BOUCHONS FEMELLES
END CAPS

PN 12.5

Met lijmaansluiting
Côté femelle à coller
Socket for solvent welding

D	DN	E	L	A	€/ST/PC
16	10	14.0	20.0	24.0	2.11
20	15	17.5	22.0	26.0	2.47
25	20	19.5	25.5	31.5	2.80
32	25	24.0	30.0	39.5	3.71
40	32	28.0	36.5	48.0	5.89
50	40	33.0	43.0	59.5	7.38
63	50	40.5	52.5	75.0	10.11
75	65	52.0	77.0	91.0	25.13
90	80	59.0	91.5	107.5	35.16
110	100	66.0	109.5	129.0	59.96

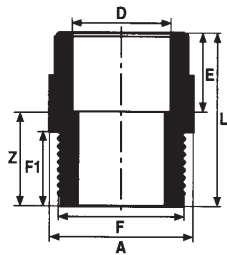

KIFV - Type A

 OVERGANGSSTUKKEN
 EMBOUTS D'ADAPTATION
 ADAPTOR COUPLINGS

PN 12.5

Eén zijde cilindrische buitendraad, andere zijde inwendige lijmaansluiting.
 Un côté mâle à filetage cylindrique, l'autre à coller comme femelle.
 One end male parallel threaded, the other end socket for solvent welding.

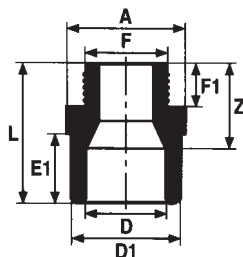

KIFV - Type B

D x G	D1	Z	E	A	L	F1	E1	TYPE	€/ST/PC
16 x 1/2"		27.5	15.0	24.5	42.5	15.0		A	4.31
16 x 3/8"	20	24.5	15.0	25.0	39.5	12.0	17.0	B	10.61
20 x 1/2	25	29.0	17.0	30.0	46.0	15.0	19.0	B	12.48
20 x 3/4"		31.5	17.0	30.0	48.5	17.0		A	5.08
25 x 3/4"	32	33.5	19.5	36.5	53.0	17.0	23.0	B	14.59
25 x 1"		35.0	21.0	36.5	56.0	19.5		A	5.17
32 x 1"	40	43.5	22.5	47.0	66.0	20.0	27.0	B	19.02
32 x 1 1/4"		40.0	23.0	47.0	63.0	21.5		A	8.38
40 x 1 1/4"	50	45.0	26.5	55.0	71.5	21.5	32.0	B	34.18
40 x 1 1/2"		42.5	27.0	48.0	69.5	22.5		A	15.67
50 x 1 1/2"	63	46.0	31.5	68.0	77.5	23.0	38.5	B	45.30
50 x 2"		49.5	32.5	60.0	82.0	27.0		A	22.32
63 x 2"	75	49.0	38.5	78.5	87.5	27.5	44.0	B	59.72
75 x 2 1/2"	90	49.5	45.0	94.0	94.5	30.5	51.8	B	72.96

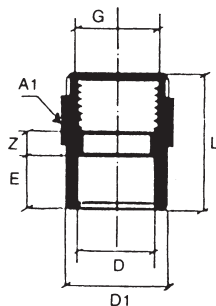

DIMV

 OVERGANGSSTUKKEN
 EMBOUTS D'ADAPTATION
 ADAPTOR COUPLINGS

PN 12.5

Eén zijde lijmof of spie, de andere inwendige draad met (BSP) met metalen versterkingsring.
 Un côté à coller, l'autre côté taraudage pas gaz cylindrique avec bague métallique de renfortement.
 One end for solvent welding, the other end female threaded (BSP) with metal reinforcing ring.

D' x D x G	DN	Z	E	L	A'	€/ST/PC
20 x 16 x 3/8"	10	5	14.0	31	23	10.61
25 x 20 x 1/2"	15	5	16.0	38	27	12.48
32 x 25 x 3/4"	20	5	19.0	42	34	14.59
40 x 32 x 1"	25	5	22.0	48	41	19.02
50 x 40 x 1 1/4"	32	11	27.5	58	55	34.18
63 x 50 x 1 1/2"	40	19	31.0	64	65	45.30
75 x 63 x 2"	50	19	32.0	85	70	59.72

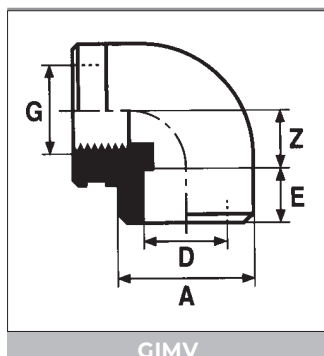

GIMV

 KNIEEN 90°
 COUDES A 90°
 ELBOWS 90°

PN 12.5

Eén zijde lijmof, andere zijde inwendige draad (BSP) met metalen versterkingsring.
 Un côté femelle à coller, l'autre côté taraudé pas gaz cylindrique avec bague métallique de renforcement.

One socket end for solvent welding, the other end female threaded (BSP) with metal reinforcing ring.

D x G	DN	Z	E	A	€/ST/PC
16 x 3/8"	10	9	15.0	24	13.20
20 x 1/2"	15	11	17.0	29	13.20
25 x 3/4"	20	14	19.5	36	14.16

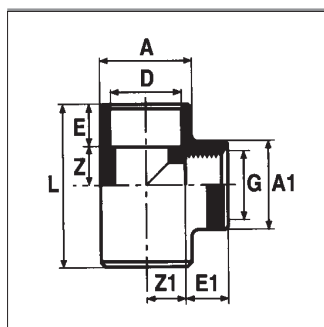

TIMV

 T-STUKKEN 90°
 TES A 90°
 TEES 90°

PN 12.5

Twee zijden lijmof, de spruit met inwendige draad (BSP) met metalen versterkingsring.
 Deux côtés femelles à coller, tubelure taraudé pas gaz cylindrique avec bague métallique de renforcement.

Two socket ends for solvent welding, female threaded (BSP) branch with metal reinforcing ring.

D x G	DN	Z	E	L	Z1	E1	A	A1	€/ST/PC
16 x 1/2"	10	9	15	48.0	12.0	17	25.0	35	11.86
20 x 1/2"	15	14	17	61.5	14.5	17	30.5	30	11.86
25 x 3/4"	20	13	20	66.5	15.5	20	35.0	40	15.57



overgangsfittings vzw messing inzetstuk
raccords d'adaptation à insert laiton
adaptor couplings with brass insert

VINKAIR

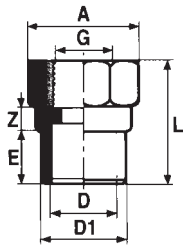

DIMM

OVERGANGSMOF BINNENDRAAD
MANCHON D'ADAPTATION FIL.FEMELLE
ADAPTOR SOCKET FEMALE THREADED

Eén zijde inwendige draad messing, andere zijde lijmstof
Un côté taraudage pas gaz cylindrique en laiton, l'autre côté à coller.
One side female brass thread, other side for solvent welding.

D x G	DN	Z	E	L	D1	A	€/ST/PC
16 x 3/8"	10	9.0	17.0	38.5	20	32.2	10.61
20 x 1/2"	15	9.0	16.5	44.0	25	36.0	12.48
25 x 3/4"	20	9.5	19.5	49.0	32	41.4	14.59
32 x 1"	25	9.8	23.0	56.4	40	49.6	19.02
40 x 1 1/4"	32	7.0	31.0	64.0	50	60.0	34.18
50 x 1 1/2"	40	7.0	37.5	69.5	63	66.0	45.30
63 x 2"	50	8.0	43.5	80.5	75	82.0	59.72

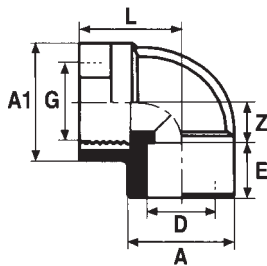

GIMM

OVERGANGSKNIE 90° BINNENDRAAD
COUDE D'ADAPTATION 90° FIL.FEMELLE
ADAPTOR ELBOW 90° FEMALE THREADED

Eén zijde inwendige draad messing, andere zijde lijmstof
Un côté taraudage pas gaz cylindrique en laiton, l'autre côté à coller.
One side female brass thread, other side for solvent welding.

D x G	DN	Z	E	A	A1	L	€/ST/PC
20 x 1/2"	15	16	16.5	29	36	32.0	13.82

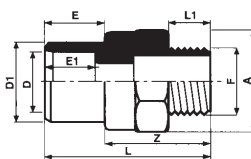

KIMM

OVERGANGSNIPPEL BUITENDRAAD
EMBOUTS D'ADAPTATION FIL.MALE
ADAPTOR NIPPLE MALE THREADED

Eén zijde uitwendige draad messing, andere zijde lijmstof
Un côté mâle taraudage pas gaz cylindrique en laiton, l'autre côté à coller.
One side male brass thread, other side for solvent welding.

D x D' x G	Z	E	E1	A	L	L1	€/ST/PC
16 x 20 x 3/8"	32.5	17.0	15.0	32.2	49.5	11.0	10.61
16 x 20 x 1/2"	36.5	16.5	14.5	32.2	53.5	13.5	12.48
20 x 25 x 1/2"	41.0	19.0	17.0	36.0	60.0	15.0	14.59
25 x 32 x 3/4"	43.0	22.5	19.5	41.0	65.0	16.0	19.02
25 x 32 x 1"	45.5	23.0	19.0	49.5	68.5	19.5	19.02
32 x 40 x 1"	49.0	27.0	23.0	49.5	76.0	19.5	19.02
40 x 50 x 1 1/4"	55.0	31.0	26.0	60.0	87.0	22.0	34.18
50 x 63 x 1 1/2"	55.0	37.5	31.0	66.0	92.0	22.0	45.30
63 x 75 x 2"	63.0	43.5	37.5	82.0	106.0	26.0	59.72

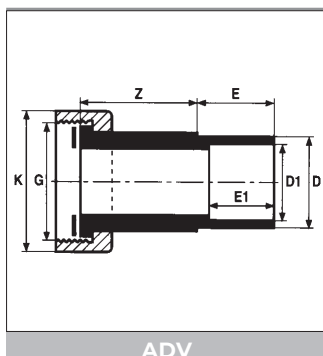
 OVERGANGSSTUKKEN
 DOUILLES DE RACCORDEMENT
 TAP CONNECTORS

PN 12.5

Overgangskoppeling met messing moer. Dichting EPDM
 Raccords d'adaptation avec écrou en laiton. Joint: EPDM
 Adaptor coupling with brass nut. Seal: EPDM

D x G	DN	Z	E	D1	E1	K	€/ST/PC
16 x 1/2"	10	20	15	12	14,0	24,0	12.82
20 x 3/4"	15	22	17	16	15,0	29,5	14.97
25 x 1"	20	23	20	20	17,0	36,0	19.47
32 x 1 1/4"	25	26	23	25	19,5	45,0	25.03
40 x 1 1/2"	32	29	27	32	23,0	52,0	38.28

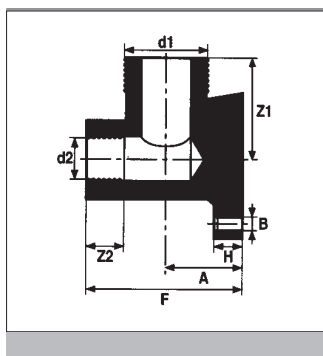
 MUURPLATEN (MESSING)
 APPLIQUES MURALES (LAITON)
 WALL BRACKETS (BRASS)

Minimale hoeveelheid: 10 stuks
 Quantité minimale: 10 pièces
 Minimum quantity: 10 pieces

d1 - d2	DN	A	B	Z1	Z2	C	D	E	F	€/ST/PC
1/2" - 3/8"	10	17.0	5	36.0	7.5	6	18	17	35.5	28.65
3/4" - 1/2"	15	18.5	5	38.0	10.0	6	20	19	42.5	37.37
1" - 3/4"	20	24.5	5	39.5	12.0	8	26	24	52.5	36.20

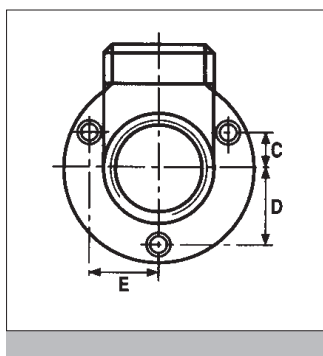



kranen
vannes
valves

VINKAIR

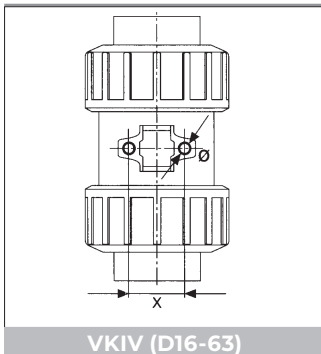

KOGELKRANEN
VANNES A BILLE
BALL VALVES

Maximale gebruikstemperatuur: 50°C.
Maximale werkdruk: 12.5 bar.
Twee zijden lijmmof.

Température maximale d'utilisation: 50°C.
Pression de service maximale: 12.5 bar.
Deux côtés femelle à coller.

Maximum working temperature: 50°C.
Maximum working pressure: 12.5 bar
Sockets for solvent welding.



d	L	Z	E	H	D	A	a	J	€/ST/PC
16	97	67	14	45	47	66	14	29	47.12
20	102	68	16	45	47	66	14	29	47.93
25	120	82	19	55	57	78	14	33	52.70
32	131	87	22	67	68	86	18	38	71.05
40	150	98	26	83	86	100	19	45	85.78
50	163	101	31	91	98	110	20	53	119.20
63	197	121	38	111	122	130	23	63	147.75
75	234	211	43	177	211	-	25	105	348.02
90	252	211	52	177	211	-	25	105	348.02
110	300	252	63	220	252	-	30	121	462.35

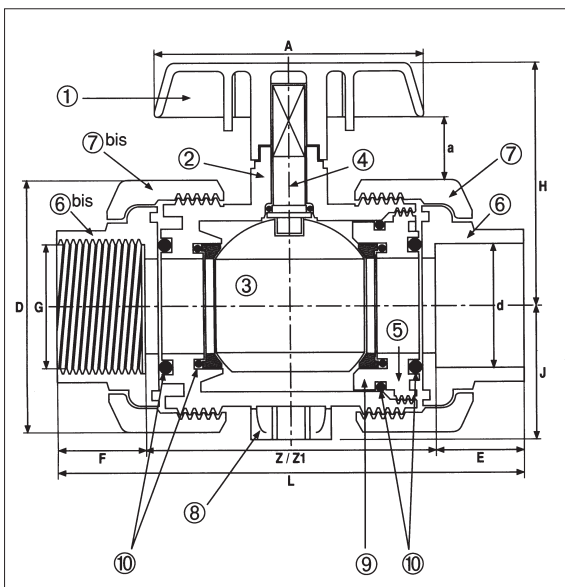

Materiaal:

- 1: handvat / poignée / ball seat: PVC-U
- 2: lichaam / corps / housing: VINKAIR
- 3: kogel / bille / ball: VINKAIR
- 4: as / axe / spindle: VINKAIR
- 5: dichtingszitting / porte-joints / gasket seat: VINKAIR
- 6: aansluitstukken / collets / collars: VINKAIR
- 7: wartelmoeren / écrous / union nuts: VINKAIR
- 8: montagevoet: inwendige draad. / supportmontage: fixation intégrée en laiton / anchoring: brass insert
- 9: dichtingsring / joint / gasket: EPDM
- 10: kogelzittingen / siège / ball seat: PTFE